

EXISTING UNDERGROUND UTILITIES:

SANITARY SEWER (S) ---
WATER LINE (W) ---
UNDERGROUND ELECTRIC (UGE) ---

EXISTING TOPOGRAPHY:

⑥ SANITARY SEWER M.H.
⑦ STORM DRAIN M.H.
⑧ WATER GATE VALE
⑨ ELECTRIC M.H.
⑩ TELEPHONE M.H.
⑪ WATER METER
⑫ FIRE HYDRANT
⑬ IRRIGATION METER
⑭ BLOW-OFF VALVE
⑮ TRAFFIC SIGN
⑯ POWER POLE
⑰ GUY ANCHOR
⑱ ELECTRICAL TEST STATION (PIPELINE)

PCC PAVEMENT
AC PAVEMENT
STAMPED CONCRETE
PALM TREE
MISC. TREE
BUILDING
TOP OF SLOPE
TOE OF SLOPE
EDGE OF PAVEMENT
DIRECTION DRAINAGE FLOW

LEGEND AND ABBREVIATIONS

PCC PAVEMENT
AC ASPHALT CONCRETE
BC BEGIN CURVE
BCR BEGIN CURVE RETURN
BO BLOW OFF
CB CATCHBASIN
C&G CURB & GUTTER
CLF CHAIN LINK FENCE
CONC CONCRETE
CONST CONSTRUCT/CONSTRUCTION
DIA DIAMETER
DWY DRIVEWAY
EC END CURVE
ECR END CURVE RETURN
ELEC ELECTRICAL/ELECTRIC
ELEV ELEVATION
E'LY EASTERLY
EV ELECTRIC VAULT
GV GATE VALVE
IP IDENTICAL POINTS
IRR IRRIGATION
LF LINEAR FEET
LS LANDSCAPE
MED MEDIAN
MH MANHOLE
MIN MINIMUM
MOD MODIFIED

N NORTH
N'LY NORTHERLY
OL OVERLAY
PB PULL BOX
PCC PORTLAND CEMENT CONCRETE
PL PLASTIC PIPE/POST
PVI POINT OF VERTICAL INTERSECTION
PVMT PAVEMENT
RET RETAINING
R&R REMOVE AND REPLACE/RECONSTRUCT
RS RISER
SGN SIGN
SF SQUARE FEET
S'LY SOUTHERLY
SS SLURRY SEAL
ST STREET
ST STATION
SW SIDEWALK
TR TREE
V DEPTH OF CATCHBASIN
W WIDTH OF CATCHBASIN
WCR WHEEL CHAIR RAMP
WM WATER METER
W'LY WESTERLY

RIVERSIDE

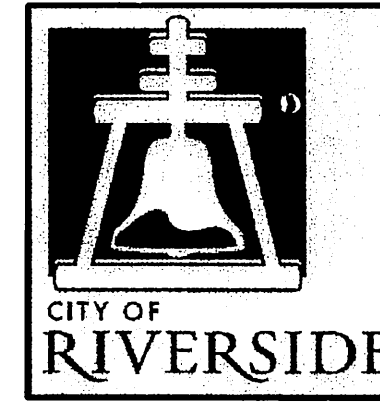

CALIFORNIA

PUBLIC WORKS DEPARTMENT HACIENDA DRIVE STORM DRAIN IMPROVEMENTS (FROM PEARBLOSSOM DRIVE TO WESTMONT STREET)

& OLD BRIDGE ROAD STORM DRAIN IMPROVEMENTS (FROM VIA VISTA DRIVE TO SUNBEAM DRIVE INCLUDING 290-FT ALONG SUNBEAM DRIVE)

GENERAL NOTES:

- EXISTING UTILITIES SHOWN ON THIS PLAN ARE APPROXIMATE. THE CONTRACTOR IS REQUIRED TO TAKE DUE PRECAUTIONARY MEASURES TO LOCATE AND PROTECT ALL UTILITIES WHETHER OR NOT SHOWN ON THIS PLAN.
- ANY TEMPORARY TRAFFIC CONTROL STRIPING OBLITERATED AND/OR BADLY WORN DURING CONSTRUCTION SHALL BE RESTORED BY THE CONTRACTOR WITHIN ONE DAY AFTER NOTIFICATION FROM THE CITY INSPECTOR.
- WHERE NEW PAVEMENT IS TO JOIN THE EXISTING PAVEMENT, THE EDGE OF THE EXISTING PAVEMENT SHALL BE TRIMMED IN A SMOOTH AND STRAIGHT LINE. CONSTRUCT MATCH-UP PAVING AS DIRECTED IN THE FIELD TO PRODUCE A SMOOTH SECTION.
- SURVEY STAKING REQUESTS AND GRADE SHEETS ARE REQUIRED FOR THE REPLACEMENT OF ALL CURBS AND/OR GUTTER OVER 50' IN LENGTH. SURVEY REQUESTS SHALL BE SUBMITTED AFTER THE EXISTING IMPROVEMENTS HAVE BEEN REMOVED. CONTRACTOR SHALL ALLOW 4 WORKING DAYS AFTER REQUESTING SURVEY TO SCHEDULE SURVEY AND PROCESS GRADE SHEETS. CONTRACTOR SHALL PROVIDE TRAFFIC CONTROL FOR ALL REQUIRED CONSTRUCTION SURVEY WORK BY CITY PERSONNEL.
- ALL HORIZONTAL AND VERTICAL ALIGNMENTS ARE APPROXIMATE AND BASED ON EXISTING ASBUILT DRAWING. THE EXISTING EDGE OF PAVEMENT SHALL BE UTILIZED FOR CONTROL, EXCEPT FOR SUNBEAM DRIVE.

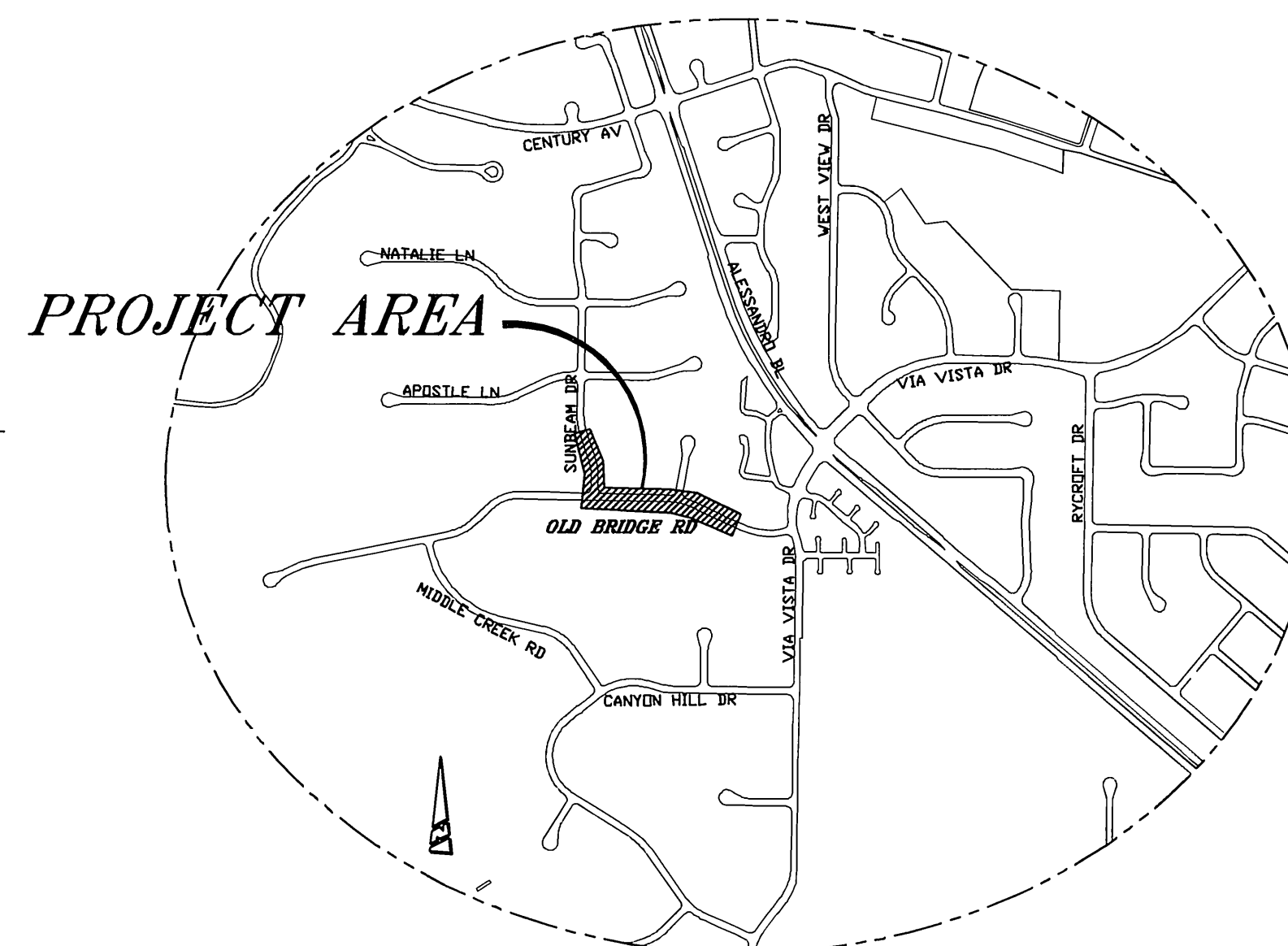

LOCATION MAP - OLD BRIDGE RD
NTS

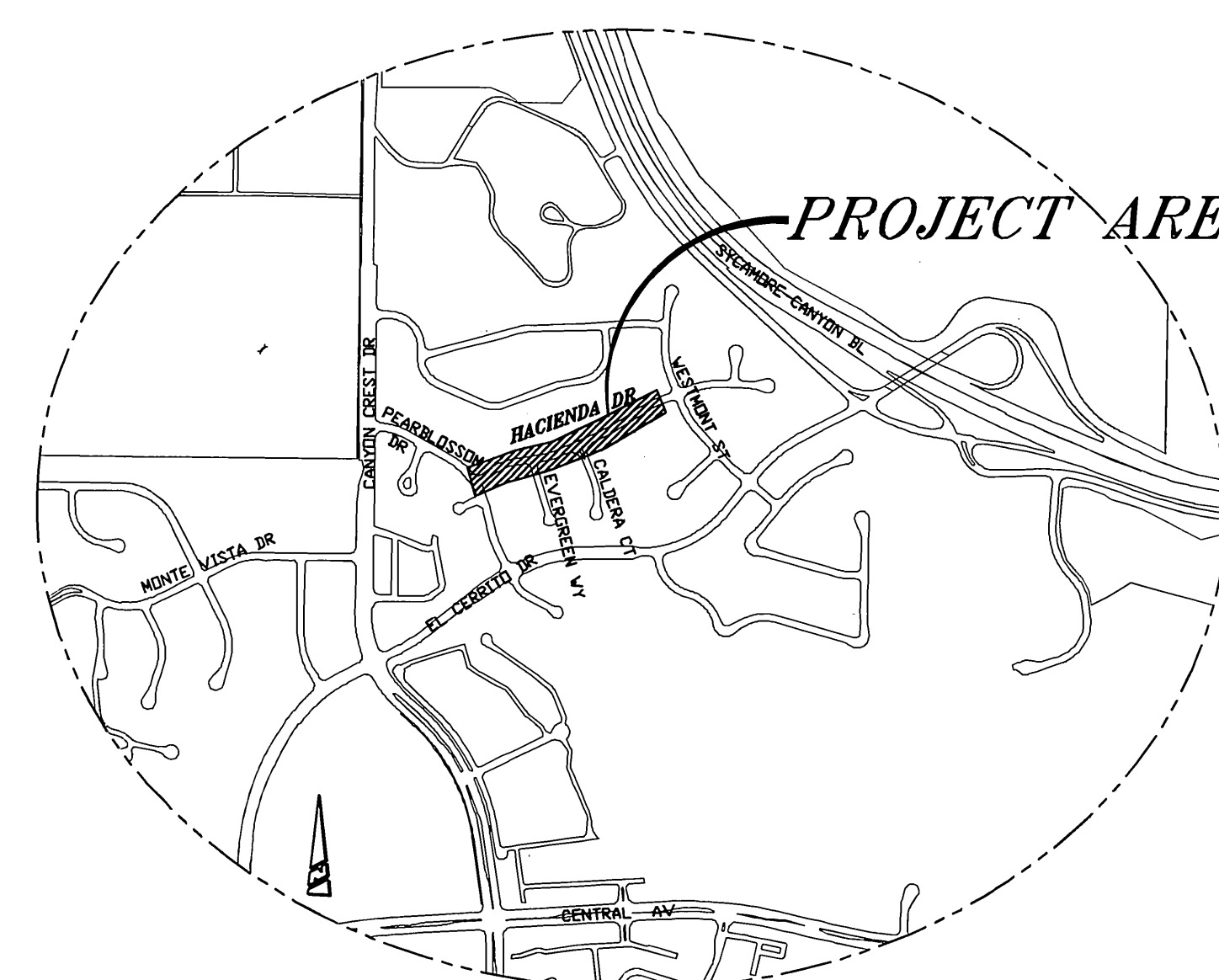

LOCATION MAP - HACIENDA DR
NTS

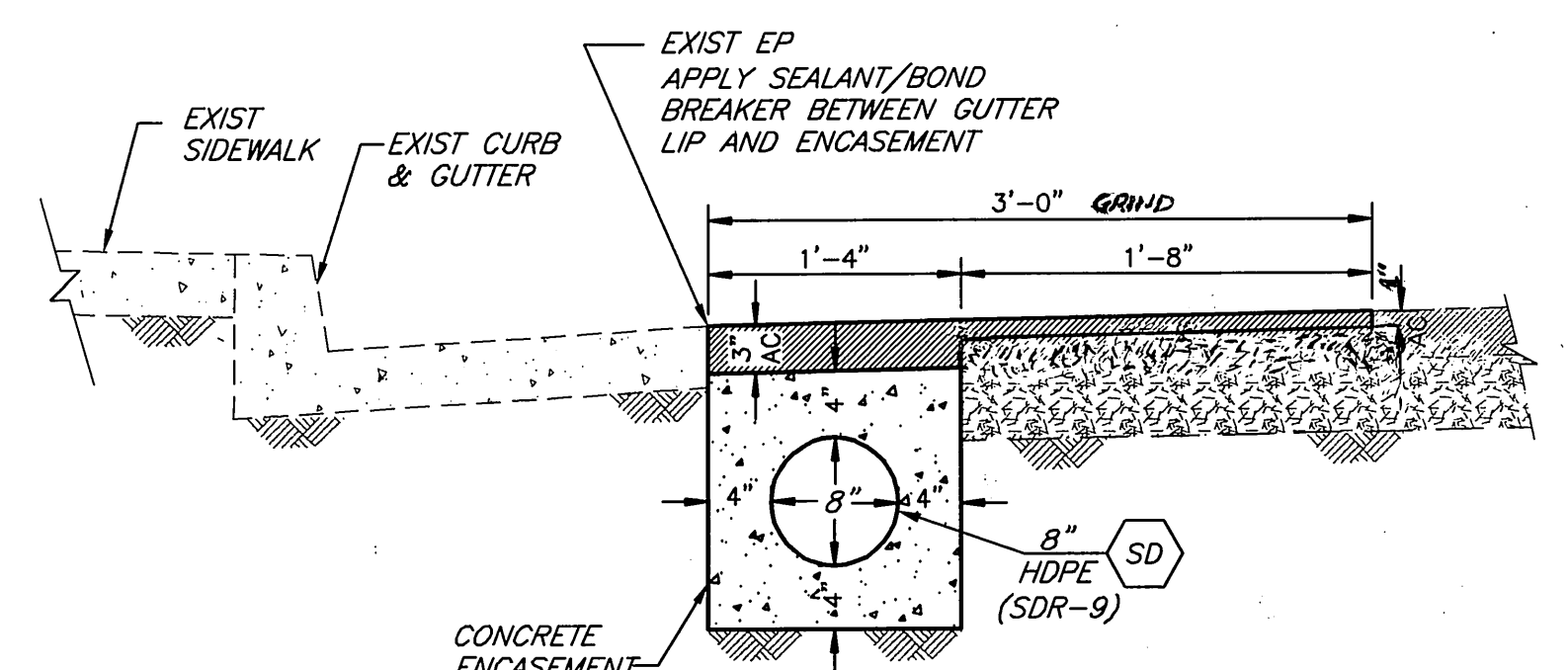
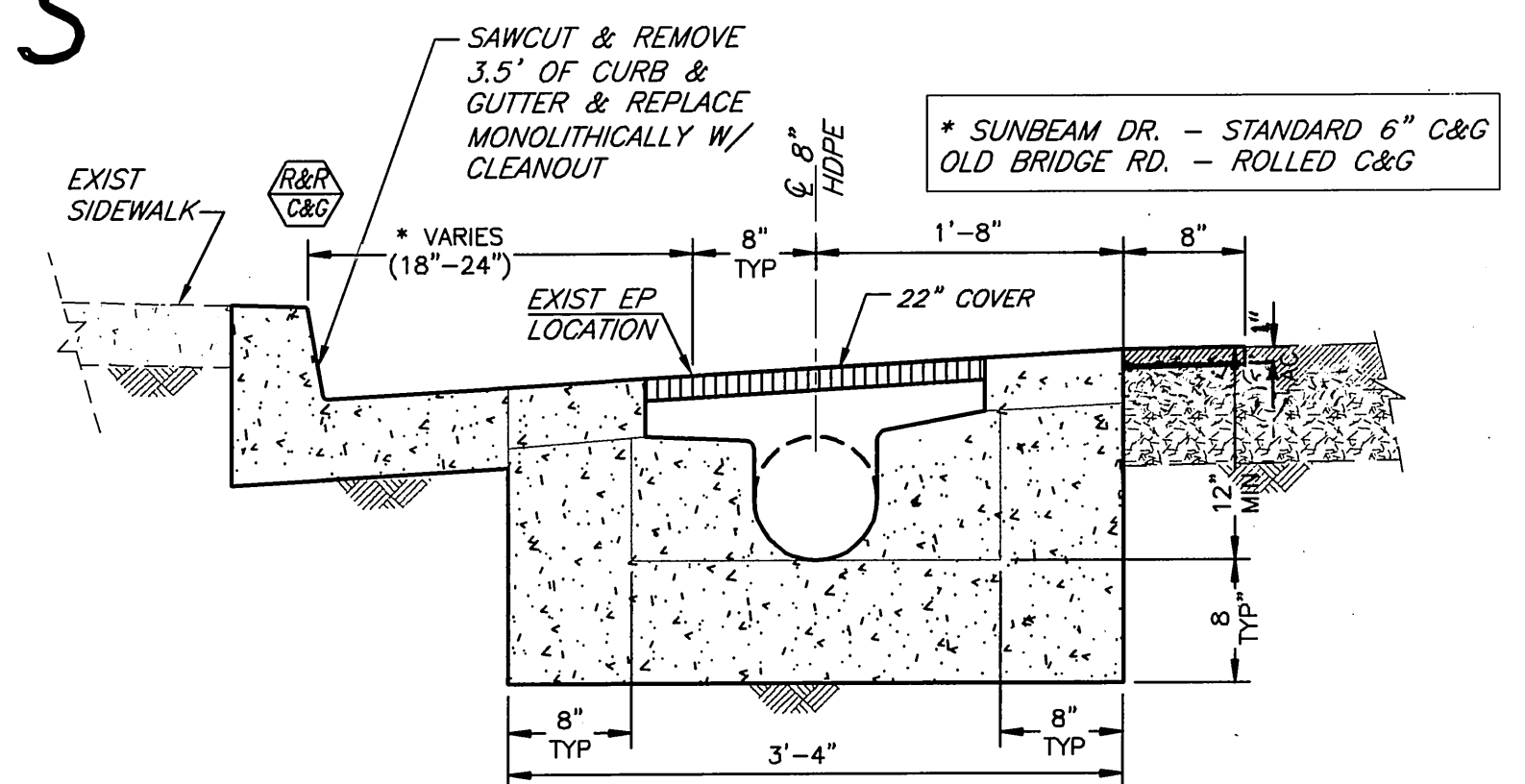

SPECIFIC NOTES: (FOR SD LINE TYPICAL SECTION)

- IF ANY UTILITY CONFLICTS ARE DETERMINED TO EXIST DURING EXCAVATION, THE CONTRACTOR SHALL NOT CONSTRUCT ANY PIPE IMPROVEMENT FOR A MINIMUM LENGTH OF 3' ON EITHER SIDE OF THE ASSOCIATED UTILITY CROSSING. THE CONTRACTOR SHALL CONTINUE TO CONSTRUCT THE PROPOSED PIPE IMPROVEMENTS. BEYOND THESE LIMITS, HOWEVER, SHALL NOT CONCRETE ENCASE A MINIMUM OF 2' BEYOND THE PIPE. TERMINATIONS ADJACENT TO THE EXPOSED UTILITY. THE CONTRACTOR SHALL BULKHEAD EACH PIPE OPENING AND BACKFILL EXPOSED OPEN TRENCH ABOVE THE UTILITY. CONFLICT WITH TEMPORARY AC. UPON DETERMINING ALL UTILITY CONFLICTS, THE CONTRACTOR SHALL COORDINATE WITH THE AFFECTED UTILITY PURVEYORS AND ALLOW 2-4 WEEKS FOR EACH UTILITY PURVEYOR TO RELOCATE THEIR FACILITIES. UPON COMPLETION OF ALL RELOCATIONS, THE CONTRACTOR SHALL COMPLETE THE REMAINING IMPROVEMENTS BY COUPLING AND ENCASING THE MISSING PIPE SECTIONS. NO COMPENSATION WILL BE PROVIDED FOR ANY WORK DESCRIBED HEREIN.
- CONTRACTOR SHALL PROVIDE A 3" MINIMUM AC SECTION OVER THE PROPOSED PIPE ENCASEMENT AND CONSTRUCT IMPROVEMENTS AS NECESSARY TO PROVIDE A UNIFORM 0.1' AC OVERLAY ACROSS THE ENTIRE 3' WIDE SECTION.
- CONCRETE SHALL BE TYPE 450-C-2000
- ADDITIONAL GRINDING DEPTH AND REMOVAL AND REPLACEMENT ARE REQUIRED AT SUNBEAM DRIVE. PIPE BEDDING AND BACKFILL REQUIREMENT SHALL APPLY FOR THOSE AREAS REQUIRING FULL REMOVAL AND REPLACEMENT.
- CONSTRUCT 4" OF AC OVER 90% COMPACTED NATIVE MATERIAL BETWEEN STA 0+32 AND STA 2+50 ON SUNBEAM DR. WHERE THERE IS A MINIMUM OF 6" COVER FROM TOP OF THE CONCRETE ENCASEMENT.
- WEAKENED PLANE JOINTS TO BE CONSTRUCTED IN 10' MAXIMUM INTERVALS THROUGHOUT LENGTH PER STANDARD PROVISIONS.
- EXPANSION JOINTS TO BE INSTALLED AT ALL INTERSECTIONS AS INDICATED.
- CONTRACTOR TO REMOVE AND REPLACE CURB AND GUTTER FOR CLEANOUT CONSTRUCTION.
- ELEVATIONS SHOWN ON THE PLANS AND PROFILES ARE APPROXIMATE. ALL INVERTS ARE 15" BELOW EXISTING FINISHED SURFACE AND ALL PIPE LINES ARE 8" FROM EDGE OF PAVEMENT.
- CONTRACTOR SHALL USE ELBOWS AS NECESSARY TO ENSURE ALL PIPE INVERTS ARE 15-INCHES BELOW FINISH SURFACE.
- 3' GRIND ASSUMED TO BE COMPLETED PRIOR TO COMMENCEMENT OF REMOVALS.
- ENCASEMENT NOT REQUIRED BEHIND CURB.
- ASSUMED NO FORMING INVOLVED CONCRETE SHALL BE POURED ADJACENT TO SAWCUT REMOVAL.
- CONTRACTOR SHALL SAWCUT AND EXCAVATE FOR THE ENTIRE PROJECT LIMITS PRIOR TO INSTALLING PIPE. AN EVALUATION OF UTILITY CONFLICTS SHALL BE ANALYZED AND ALL OPEN TRENCHES SHALL BE PLATED. IF UTILITY CONFLICTS ARE DETERMINED TO EXIST, CONTRACTOR SHALL SHUT-DOWN OPERATIONS FOR 2-4 WEEKS AND SCHEDULE ALL UTILITY RELOCATIONS AS NECESSARY. NO COMPENSATION WILL BE PROVIDED FOR CONSTRUCTION DOWN TIME.

SHEET INDEX: STREET IMPROVEMENTS

SHEET NO.	DESCRIPTION
1	TITLE SHEET
2	HACIENDA DR. STA 0+00 TO STA 5+00
3	HACIENDA DR. STA 5+00 TO STA 9+00
4	SUNBEAM DR. STA 0+00 TO STA 3+00 & OLD BRIDGE RD. STA 119+56 TO STA 120+00
5	OLD BRIDGE RD. STA 120+00 TO STA 125+00
6	OLD BRIDGE RD. STA 125+00 TO STA 130+00

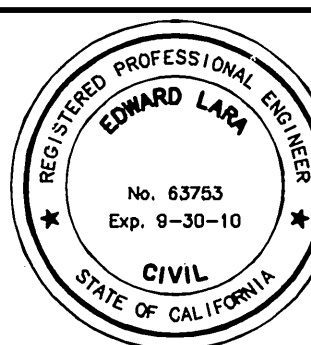
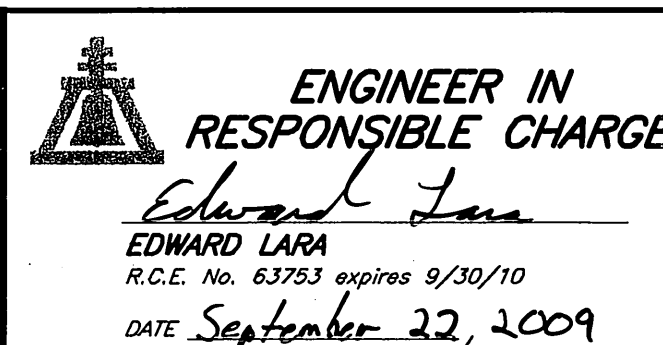

MARK	REVISIONS	APPROV.	DATE
DESIGNED BY: JUE	DRAWN BY: JUE	CHECKED BY: EL	

CITY OF RIVERSIDE, CALIFORNIA PUBLIC WORKS DEPARTMENT	
APPROVED BY PRINCIPAL ENGINEER STREET SERVICES CONST. CONF. ADMIN. DATE: 9/22/09	APPROVED BY CITY ENGINEER DATE: 9/22/09

HACIENDA DR. STORM DRAIN & OLD BRIDGE RD. STORM DRAIN IMPROVEMENTS
TITLE SHEET

W.O. DESIGN: 0917176, 0804581 W.O. CC/ST: 1012328
D-841
SHEET 1 OF 6
FILE NO.

CONSTRUCTION NOTES

NUMBERS ABOVE 100 IN A HEXAGON ON THE PLAN REFER TO THE RESPECTIVE STANDARD DRAWING AND SHALL BE CONSTRUCTED ACCORDINGLY, UNLESS MODIFICATIONS ARE NOTED ON THE PLAN. ANY NUMBER SHOWN BELOW THE STANDARD DRAWING NUMBER INDICATES THE SPECIFIC ALTERNATE TO BE CONSTRUCTED.

PROTECT IN PLACE EXISTING FACILITY (XX=TYPE PER PLAN). THE FOLLOWING IS THE FACILITY LEGEND:
 -- GL=GUTTER LIP OR OTHERWISE NOTED.

REMOVE EXISTING FACILITY (XX=TYPE PER PLAN). THE FOLLOWING IS THE FACILITY LEGEND:
 -- C&G=CURB & GUTTER

MINIMUM 24" WIDE 16" DEEP STRUCTURAL SECTION TO BE REMOVED FOR PIPE INSTALLATION, FILL VOID WITH FULL-DEPTH AC. 8" MIN. WIDTH. (SEE DETAIL ON SHEET 1).

COMPLETE ALL REMOVALS, INSTALL CONCRETE ENCASED 8" DIAMETER (HDPE) STORM DRAIN PIPE, AND REPLACE AC PER DETAIL ON SHEET 1.

INSTALL CLEANOUT PER STD DRAWING #425 AND PER DETAIL ON SHEET 1 W/ THE FOLLOWING MODIFICATION:
 -- THE WALLS TOP AND BOTTOM THICKNESSES SHALL BE REVISED TO REFLECT THE REQUIREMENTS INDICATED ON CITY STD DRAWING 431, INCLUDING REINFORCEMENT AND EXCLUDING SHAFT.
 -- REMOVE CURB & GUTTER AND REPLACE MONOLITHICALLY.
 -- ANGLE OF CONNECTION TO BE 90° UNLESS OTHERWISE NOTED.

INSTALL TRENCH BACKFILL PER STD DRAWING #453 WITH THE FOLLOWING MODIFICATION:
 -- FULL DEPTH REMOVAL TO BE COMPLETED PER PIPE X-SECTION DETAIL ON SHEET 1.
 -- BACKFILL TO BE 4" AC OVER 90% COMPACTED NATIVE.

CONNECT TO EXISTING CATCH BASIN PER APWA STD DRAWING 308-1.

MODIFY EXISTING CATCH BASIN AND JOIN EXISTING BASIN ANGLE OF CONNECTION PER PLAN.

GRIND 3' OF AC PRIOR TO COMMENCEMENT OF REMOVALS. SEE DETAIL ON SHEET-1.

ELEVATIONS AND STATIONS ARE APPROXIMATE ON ALL PLANS

HORIZ. SCALE: 1" = 20'
 VERT. SCALE: 1" = 4'

1+00

2+00

3+00

4+00

5+00

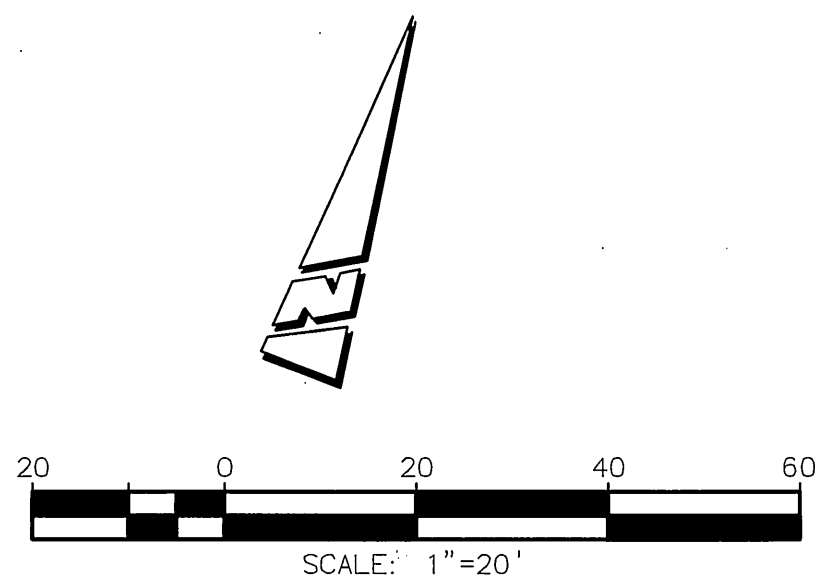
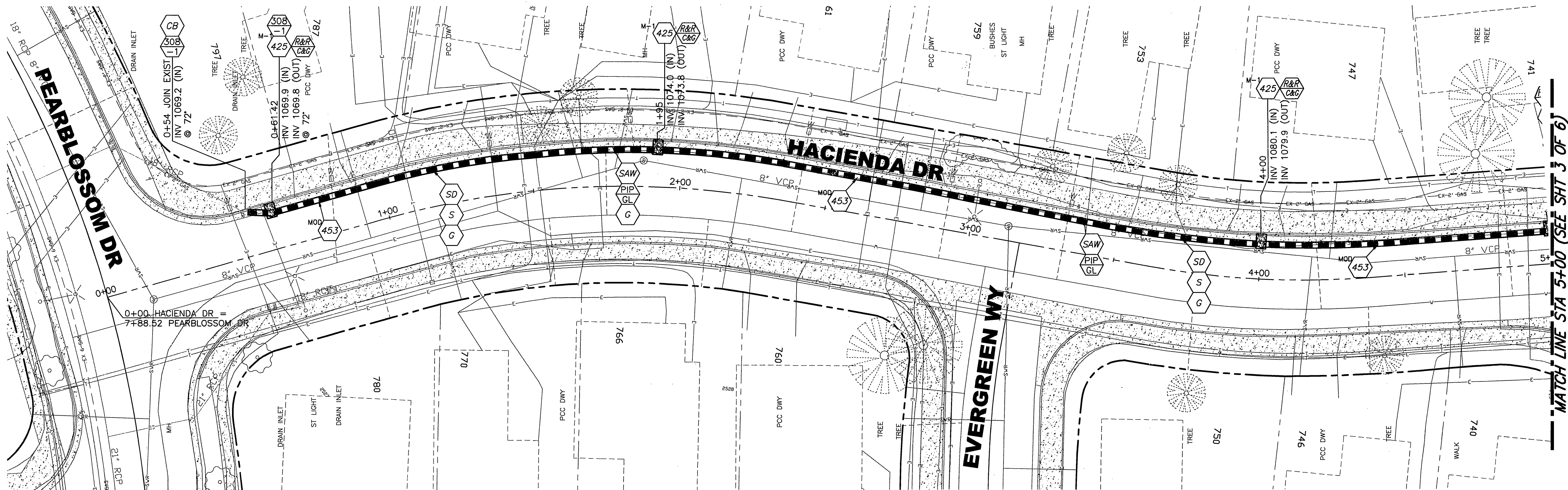

Underground Service Alert
 CALL BEFORE YOU DIG
 CALL-TOLL FREE
 1-800
 227-2600
 TWO WORKING DAYS BEFORE YOU DIG

ENGINEER IN RESPONSIBLE CHARGE
 Edward Lara
 R.C.E. No. 63753 expires 9/30/10
 DATE September 21, 2009

REGISTERED PROFESSIONAL ENGINEER
 EDWARD LARA
 No. 63753
 Exp. 9-30-10
 CIVIL
 STATE OF CALIFORNIA

CITY OF RIVERSIDE, CALIFORNIA
 PUBLIC WORKS DEPARTMENT
 APPROVED BY: [Signature]
 DATE: 9/20/09
 DESIGNED BY: JUE DRAWN BY: JUE CHECKED BY: EL

HACIENDA DR. STORM DRAIN & OLD BRIDGE RD. STORM DRAIN IMPROVEMENTS
 HACIENDA DR. STA 0+00 STA 5+00
 HORIZ. SCALE: 1" = 20'
 VERT. SCALE: 1" = 4'

W.O. DESIGN: 0917176, 0804581
 W.O. CONST: 1012328
 D-841
 SHEET 2 OF 6
 FILE NO.

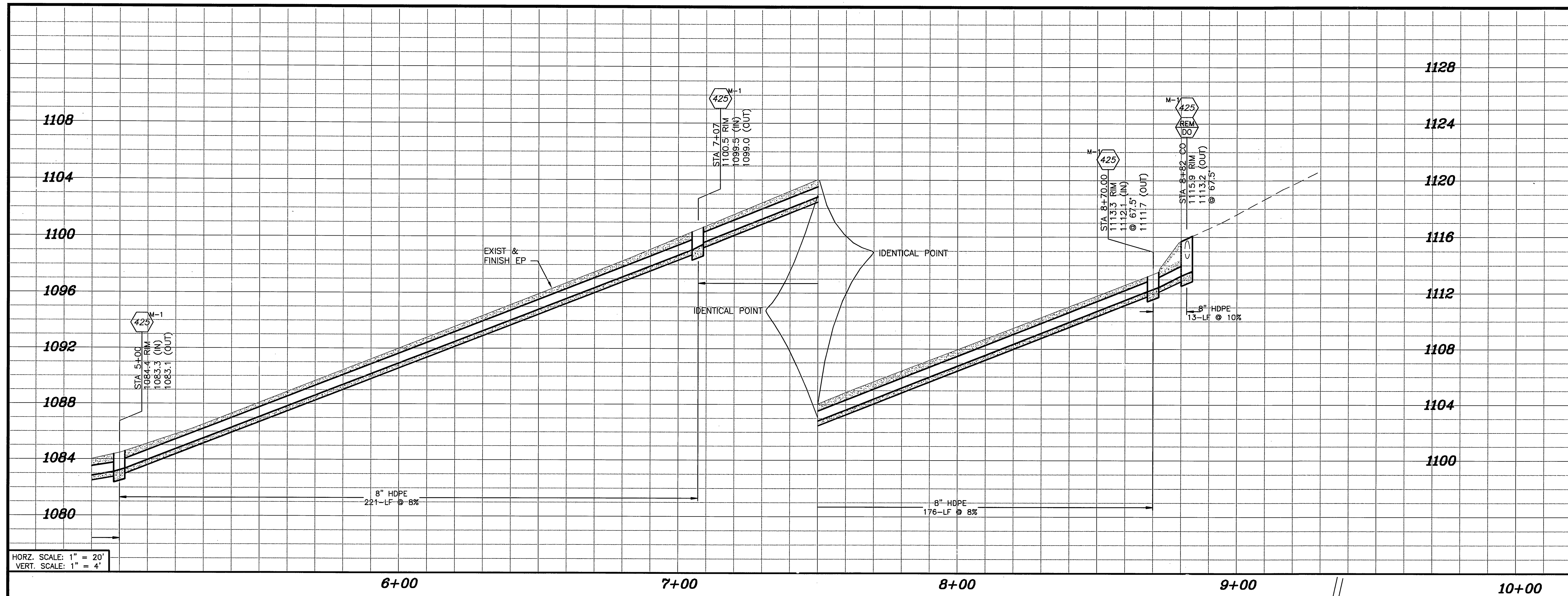

CONSTRUCTION NOTES

- NUMBERS ABOVE 100 IN A HEXAGON ON THE PLAN REFER TO THE RESPECTIVE STANDARD DRAWING AND SHALL BE CONSTRUCTED ACCORDINGLY, UNLESS MODIFICATIONS ARE NOTED ON THE PLAN. ANY NUMBER SHOWN BELOW THE STANDARD DRAWING NUMBER INDICATES THE SPECIFIC ALTERNATE TO BE CONSTRUCTED.
- PROTECT IN PLACE EXISTING FACILITY (XX=TYPE PER PLAN). THE FOLLOWING IS THE FACILITY LEGEND:
 - GL=GUTTER LIP OR OTHERWISE NOTED.
- REMOVE EXISTING FACILITY (XX=TYPE PER PLAN). THE FOLLOWING IS THE FACILITY LEGEND:
 - C&G=CURB & GUTTER
- MINIMUM 24" WIDE 16" DEEP STRUCTURAL SECTION TO BE REMOVED FOR PIPE INSTALLATION, FILL VOID WITH FULL-DEPTH AC. 8" MIN. WIDTH. (SEE DETAIL ON SHEET 1).
- COMPLETE ALL REMOVALS, INSTALL CONCRETE ENCASED 8" DIAMETER (HDPE) STORM DRAIN PIPE, AND REPLACE AC PER DETAIL ON SHEET 1.
- INSTALL CLEANOUT PER STD DRAWING #425 AND PER DETAIL ON SHEET 1 W/ THE FOLLOWING MODIFICATION:
 - THE WALLS TOP AND BOTTOM THICKNESSES SHALL BE REVISED TO REFLECT THE REQUIREMENTS INDICATED ON CITY STD DRAWING 431, INCLUDING REINFORCEMENT AND EXCLUDING SHAFT.
 - REMOVE CURB & GUTTER AND REPLACE MONOLITHICALLY.
 - ANGLE OF CONNECTION TO BE 90° UNLESS OTHERWISE NOTED.
- INSTALL TRENCH BACKFILL PER STD DRAWING #453 WITH THE FOLLOWING MODIFICATION:
 - FULL DEPTH REMOVAL TO BE COMPLETED PER PIPE X-SECTION DETAIL ON SHEET 1.
 - BACKFILL TO BE 4" AC OVER 90% COMPACTED NATIVE.
- CONNECT TO EXISTING CATCH BASIN PER APWA STD DRAWING 308-1.
- MODIFY EXISTING CATCH BASIN AND JOIN EXISTING BASIN ANGLE OF CONNECTION PER PLAN.
- GRIND 3' OF AC PRIOR TO COMMENCEMENT OF REMOVALS. SEE DETAIL ON SHEET-1.

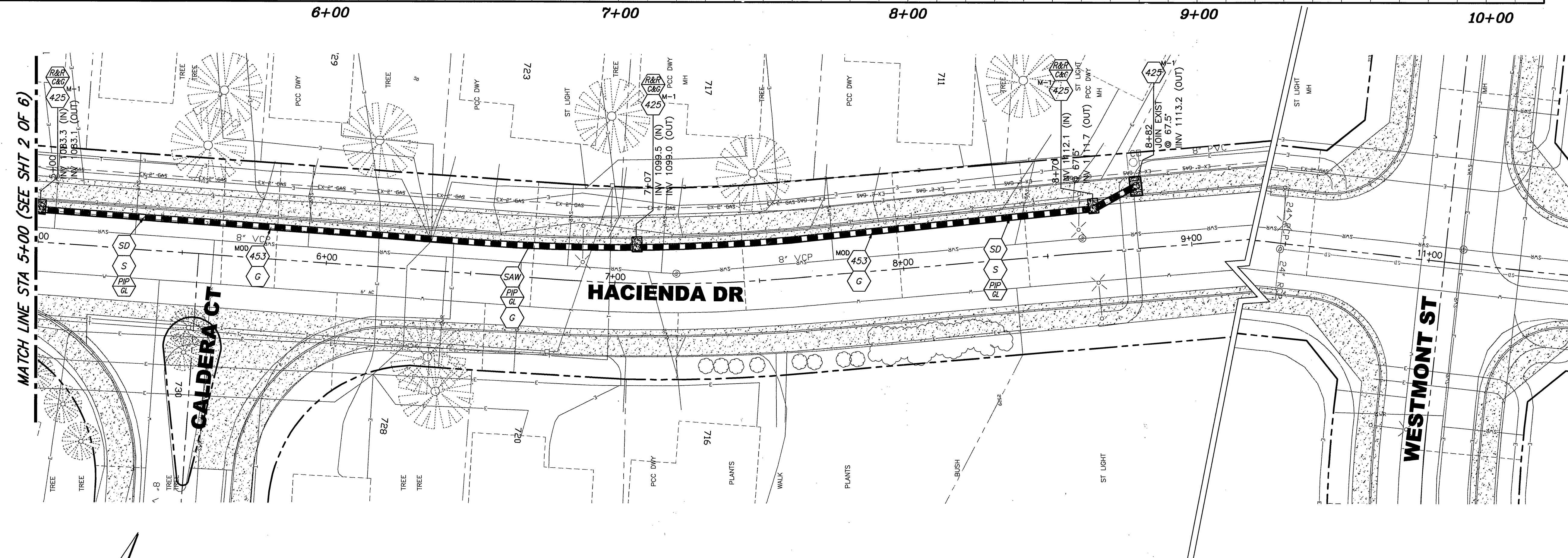

ELEVATIONS AND STATIONS ARE APPROXIMATE ON ALL PLANS

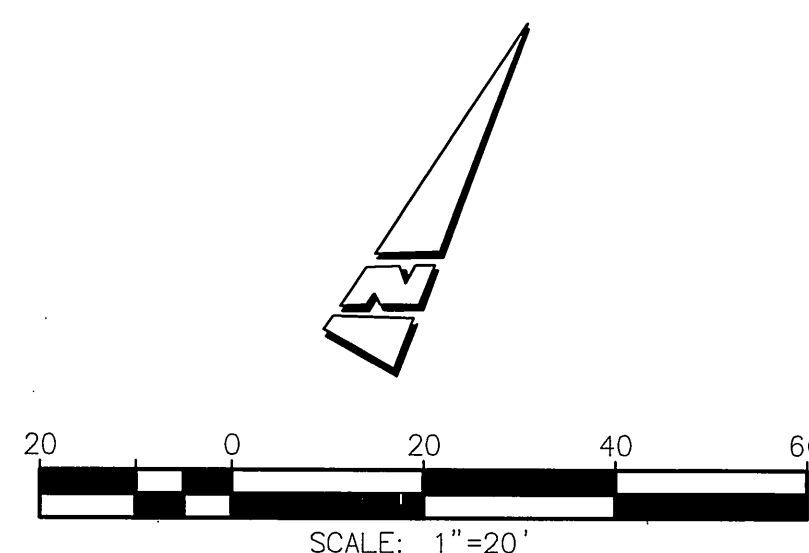

Underground Service Alert
CALL BEFORE YOU DIG
CALL-TOLL FREE
1-800
227-2600
TWO WORKING DAYS BEFORE YOU DIG

ENGINEER IN RESPONSIBLE CHARGE
Edward Lara
EDWARD LARA
R.G.E. No. 63753 expires 9/30/10
DATE September 21, 2009

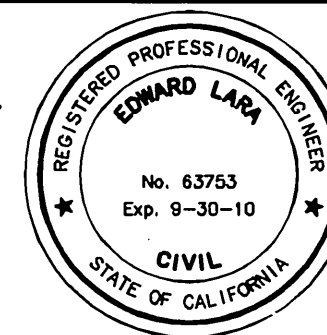

MARK	REVISIONS	APPR.	DATE
DESIGNED BY: JUE	DRAWN BY: JUE	CHECKED BY: EL	

CITY OF RIVERSIDE, CALIFORNIA
PUBLIC WORKS DEPARTMENT
APPROVED BY: *[Signature]* DATE: 9/20/09
CITY ENGINEER

HACIENDA DR. STORM DRAIN & OLD BRIDGE RD. STORM DRAIN IMPROVEMENTS
HACIENDA DR. STA 5+00 STA 9+00
HORIZ. SCALE: 1" = 20'
VERT. SCALE: 1" = 4'

W.O. DESIGN: 0917176, 0804581
W.O. CONST: 1012328
D-841
SHEET 3 OF 6
FILE NO.

CONSTRUCTION NOTES

- NUMBERS ABOVE 100 IN A HEXAGON ON THE PLAN REFER TO THE RESPECTIVE STANDARD DRAWING AND SHALL BE CONSTRUCTED ACCORDINGLY, UNLESS MODIFICATIONS ARE NOTED ON THE PLAN. ANY NUMBER SHOWN BELOW THE STANDARD DRAWING NUMBER INDICATES THE SPECIFIC ALTERNATE TO BE CONSTRUCTED.**
- PROTECT IN PLACE EXISTING FACILITY (XX=TYPE PER PLAN). THE FOLLOWING IS THE FACILITY LEGEND:**
- GL=GUTTER LIP OR OTHERWISE NOTED.
- REMOVE EXISTING FACILITY (XX=TYPE PER PLAN). THE FOLLOWING IS THE FACILITY LEGEND:**
- C&G=CURB & GUTTER
- MINIMUM 24" WIDE 16" DEEP STRUCTURAL SECTION TO BE REMOVED FOR PIPE INSTALLATION, FILL VOID WITH FULL-DEPTH AC. 8" MIN. WIDTH. (SEE DETAIL ON SHEET-1).**
- COMPLETE ALL REMOVALS, INSTALL CONCRETE ENCASED 8" DIAMETER (HDPE) STORM DRAIN PIPE, AND REPLACE AC PER DETAIL ON SHEET-1.**
- INSTALL CLEANOUT PER STD DRAWING #425 AND PER DETAIL ON SHEET-1 W/ THE FOLLOWING MODIFICATION:**
-- THE WALLS TOP AND BOTTOM THICKNESSES SHALL BE REVISED TO REFLECT THE REQUIREMENTS INDICATED ON CITY STD DRAWING 431, INCLUDING REINFORCEMENT AND EXCLUDING SHAFT.
-- REMOVE CURB & GUTTER AND REPLACE MONOLITHICALLY.
-- ANGLE OF CONNECTION TO BE 90° UNLESS OTHERWISE NOTED.
- INSTALL TRENCH BACKFILL PER STD DRAWING #453 WITH THE FOLLOWING MODIFICATION:**
-- FULL DEPTH REMOVAL TO BE COMPLETED PER PIPE X-SECTION DETAIL ON SHEET-1.
-- BACKFILL TO BE 4" AC OVER 90% COMPACTED NATIVE.
- CONNECT TO EXISTING CATCH BASIN PER APWA STD DRAWING 308-1.**
- MODIFY EXISTING CATCH BASIN AND JOIN EXISTING BASIN ANGLE OF CONNECTION PER PLAN.**
- EXPANSION JOINT AT MID SPAN OF PIPE.**
- EXPANSION JOINT AT CLEANOUT/CATCH BASIN CONNECTION**
- GRIND 3" OF AC PRIOR TO COMMENCEMENT OF REMOVALS. SEE DETAIL ON SHEET-1.**

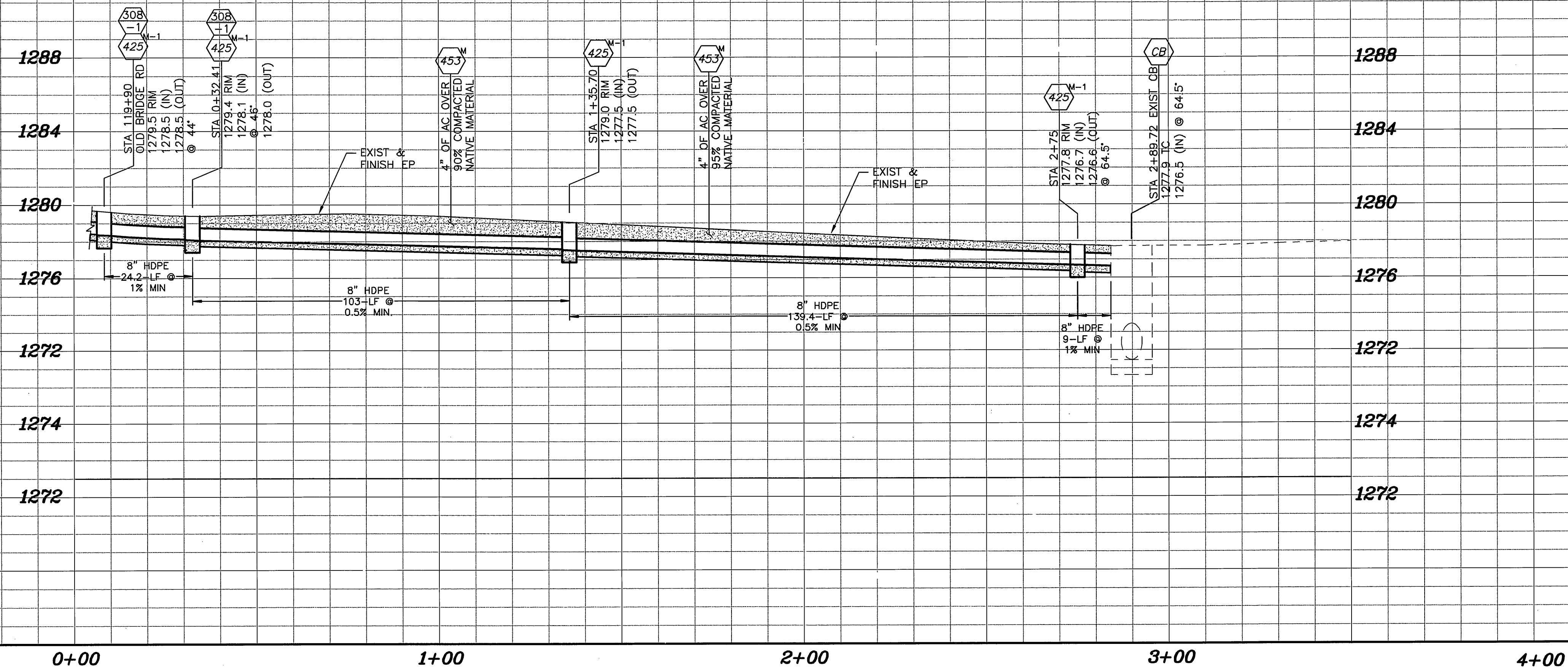

HORZ. SCALE: 1" = 20'
VERT. SCALE: 1" = 4'

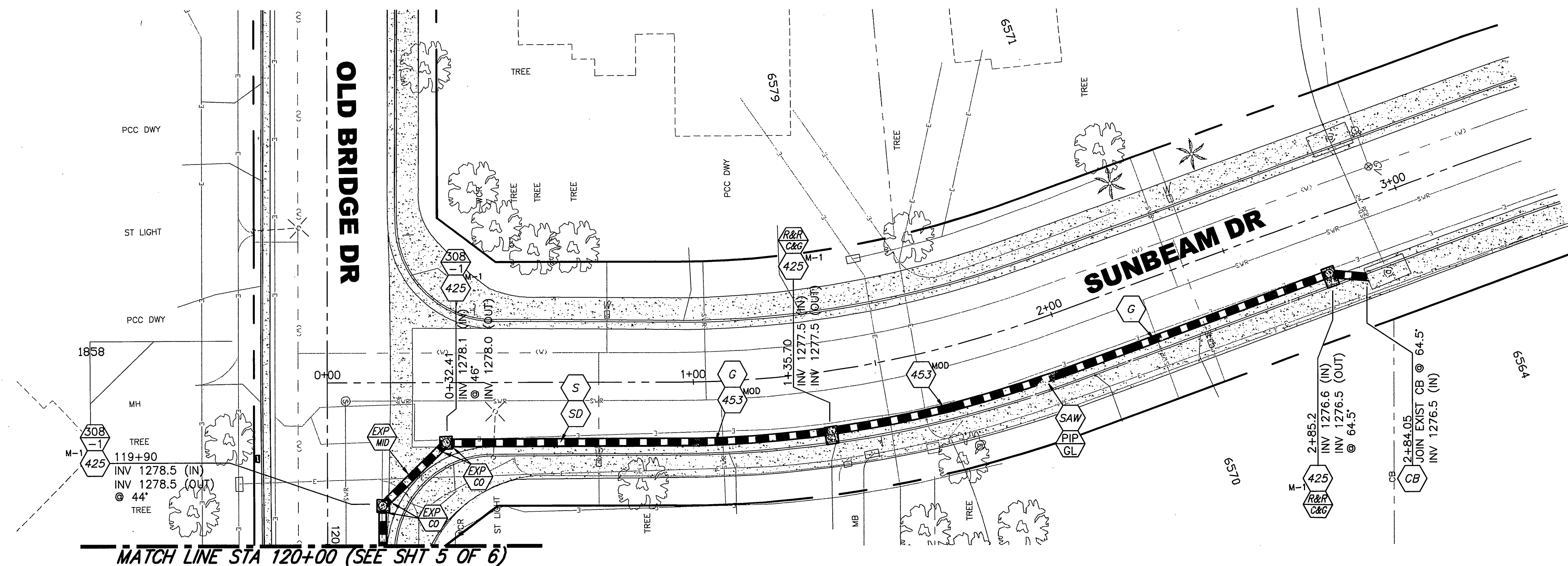

ELEVATIONS AND STATIONS ARE APPROXIMATE ON ALL PLANS

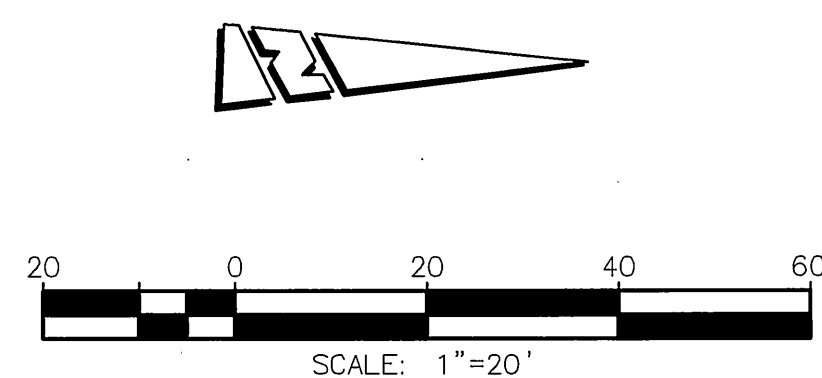

Underground Service Alert
CALL BEFORE YOU DIG
CALL-TOLL FREE
1-800
227-2600
TWO WORKING DAYS BEFORE YOU DIG

ENGINEER IN RESPONSIBLE CHARGE
Edward Lara
EDWARD LARA
R.C.E. No. 63753 expires 9/30/10
DATE *September 22, 2009*

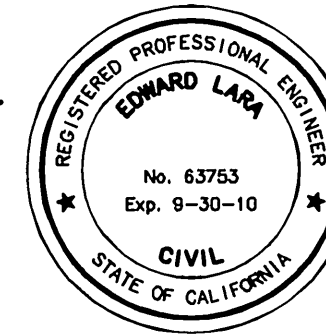

DESIGNED BY	DRAWN BY	CHECKED BY	DATE
JUE	JUE	EL	

CITY OF RIVERSIDE, CALIFORNIA PUBLIC WORKS DEPARTMENT			
APPROVED BY	DATE	APPROVED BY	DATE
Principal Engineer	7/30/09	City Engineer	7/30/09

HACIENDA DR. STORM DRAIN & OLD BRIDGE RD. STORM DRAIN IMPROVEMENTS
SUNBEAM DR. STA 0+00 STA 3+00
OLD BRIDGE RD. STA 119+56 STA 120+00
HORIZ. SCALE: 1" = 20'
VERT. SCALE: 1" = 4'

W.O. DESIGN: 0917176, 0804581
W.O. CONST: 1012328
D-841
SHEET **4** OF **6**
FILE NO.

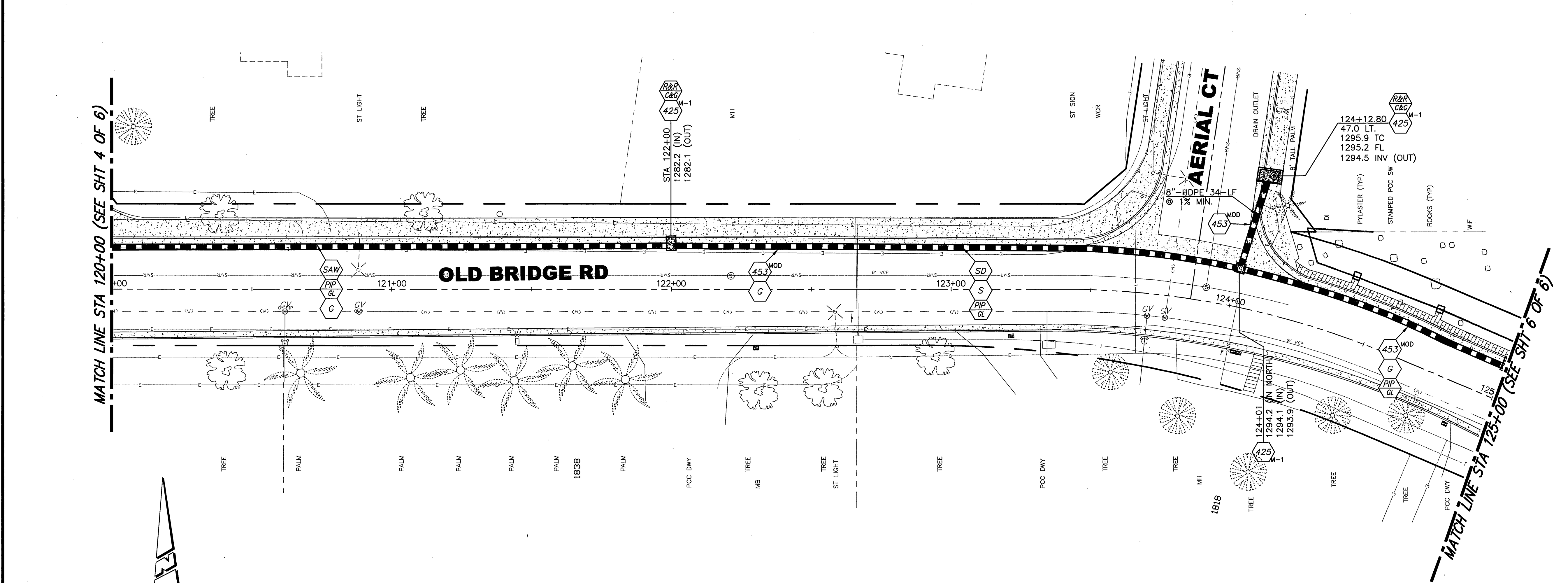
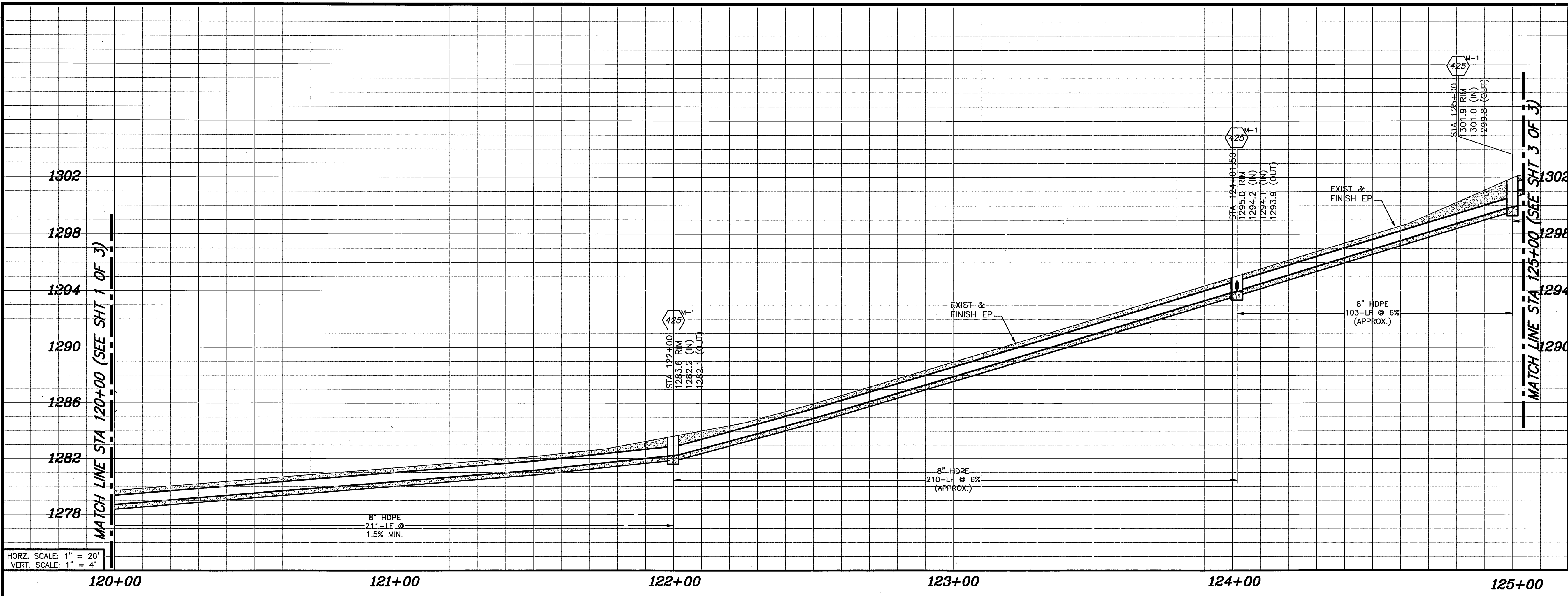

- ### CONSTRUCTION NOTES
- NUMBERS ABOVE 100 IN A HEXAGON ON THE PLAN REFER TO THE RESPECTIVE STANDARD DRAWING AND SHALL BE CONSTRUCTED ACCORDINGLY, UNLESS MODIFICATIONS ARE NOTED ON THE PLAN. ANY NUMBER SHOWN BELOW THE STANDARD DRAWING NUMBER INDICATES THE SPECIFIC ALTERNATE TO BE CONSTRUCTED.
 - PROTECT IN PLACE EXISTING FACILITY (XX=TYPE PER PLAN). THE FOLLOWING IS THE FACILITY LEGEND:
-- GL=GUTTER LIP OR OTHERWISE NOTED.
 - REMOVE EXISTING FACILITY (XX=TYPE PER PLAN). THE FOLLOWING IS THE FACILITY LEGEND:
-- C&G=CURB & GUTTER
 - MINIMUM 24" WIDE 16" DEEP STRUCTURAL SECTION TO BE REMOVED FOR PIPE INSTALLATION, FILL VOID WITH FULL-DEPTH AC. 8" MIN. WIDTH. (SEE DETAIL ON SHEET-1).
 - COMPLETE ALL REMOVALS, INSTALL CONCRETE ENCASED 8" DIAMETER (HDPE) STORM DRAIN PIPE, AND REPLACE AC PER DETAIL ON SHEET-1.
 - INSTALL CLEANOUT PER STD DRAWING #425 AND PER DETAIL ON SHEET-1 W/ THE FOLLOWING MODIFICATION:
-- THE WALLS TOP AND BOTTOM THICKNESSES SHALL BE REVISED TO REFLECT THE REQUIREMENTS INDICATED ON CITY STD DRAWING 431, INCLUDING REINFORCEMENT AND EXCLUDING SHAFT.
-- REMOVE CURB & GUTTER AND REPLACE MONOLITHICALLY.
-- ANGLE OF CONNECTION TO BE 90° UNLESS OTHERWISE NOTED.
 - INSTALL TRENCH BACKFILL PER STD DRAWING #453 WITH THE FOLLOWING MODIFICATION:
-- FULL DEPTH REMOVAL TO BE COMPLETED PER PIPE X-SECTION DETAIL ON SHEET-1.
-- BACKFILL TO BE 4" AC OVER 90% COMPACTED NATIVE.
 - CONNECT TO EXISTING CATCH BASIN PER APWA STD DRAWING 308-1.
 - MODIFY EXISTING CATCH BASIN AND JOIN EXISTING BASIN ANGLE OF CONNECTION PER PLAN.
 - EXPANSION JOINT AT MID SPAN OF PIPE.
 - EXPANSION JOINT AT CLEANOUT/CATCH BASIN CONNECTION
 - GRIND 3' OF AC PRIOR TO COMMENCEMENT OF REMOVALS. SEE DETAIL ON SHEET-1.

ELEVATIONS AND STATIONS ARE APPROXIMATE ON ALL PLANS

SCALE: 1"=20'

Underground Service Alert
CALL BEFORE YOU DIG
CALL TOLL FREE
1-800-227-2600
TWO WORKING DAYS BEFORE YOU DIG

ENGINEER IN RESPONSIBLE CHARGE
Edward Lara
EDWARD LARA
R.C.E. No. 63753 expires 9/30/10
DATE September 22, 2009

CITY OF RIVERSIDE, CALIFORNIA
PUBLIC WORKS DEPARTMENT

APPROVED BY:	DATE:	APPROVED BY:	DATE:
PRINCIPAL ENGINEER	9/20/09	CITY ENGINEER	9/20/09
STREET SERVICES	9/20/09		
CONST. CONT. ADMIN.	9/20/09		

DESIGNED BY: JUE DRAWN BY: JUE CHECKED BY: EL

HACIENDA DR. STORM DRAIN & OLD BRIDGE RD. STORM DRAIN IMPROVEMENTS

OLD BRIDGE RD. STA 120+56 STA 125+00

HORIZ. SCALE: 1" = 20'
VERT. SCALE: 1" = 4'

W.O. DESIGN: 0917176, 0804581
W.O. CONST: 1012328

D-841

SHEET 5 OF 6

FILE NO.

CONSTRUCTION NOTES

NUMBERS ABOVE 100 IN A HEXAGON ON THE PLAN REFER TO THE RESPECTIVE STANDARD DRAWING AND SHALL BE CONSTRUCTED ACCORDINGLY, UNLESS MODIFICATIONS ARE NOTED ON THE PLAN. ANY NUMBER SHOWN BELOW THE STANDARD DRAWING NUMBER INDICATES THE SPECIFIC ALTERNATE TO BE CONSTRUCTED.

PROTECT IN PLACE EXISTING FACILITY (XX=TYPE PER PLAN). THE FOLLOWING IS THE FACILITY LEGEND:
- GL=GUTTER LIP OR OTHERWISE NOTED.

REMOVE EXISTING FACILITY (XX=TYPE PER PLAN). THE FOLLOWING IS THE FACILITY LEGEND:
- C&G=CURB & GUTTER

MINIMUM 24" WIDE 16" DEEP STRUCTURAL SECTION TO BE REMOVED FOR PIPE INSTALLATION. FILL VOID WITH FULL-DEPTH AC. 8" MIN. WIDTH. (SEE DETAIL ON SHEET-1).

COMPLETE ALL REMOVALS, INSTALL CONCRETE ENCASED 8" DIAMETER (HDPE) STORM DRAIN PIPE, AND REPLACE AC PER DETAIL ON SHEET-1.

INSTALL CLEANOUT PER STD DRAWING #425 AND PER DETAIL ON SHEET-1 W/ THE FOLLOWING MODIFICATION:
-- THE WALLS TOP AND BOTTOM THICKNESSES SHALL BE REVISED TO REFLECT THE REQUIREMENTS INDICATED ON CITY STD DRAWING 431, INCLUDING REINFORCEMENT AND EXCLUDING SHAFT.
-- REMOVE CURB & GUTTER AND REPLACE MONOLITHICALLY.
-- ANGLE OF CONNECTION TO BE 90° UNLESS OTHERWISE NOTED.

INSTALL TRENCH BACKFILL PER STD DRAWING #453 WITH THE FOLLOWING MODIFICATION:
-- FULL DEPTH REMOVAL TO BE COMPLETED PER PIPE X-SECTION DETAIL ON SHEET-1.
-- BACKFILL TO BE 4" AC OVER 90% COMPACTED NATIVE.

CONNECT TO EXISTING CATCH BASIN PER APWA STD DRAWING 308-1.

MODIFY EXISTING CATCH BASIN AND JOIN EXISTING BASIN ANGLE OF CONNECTION PER PLAN.

EXPANSION JOINT AT MID SPAN OF PIPE.

EXPANSION JOINT AT CLEANOUT/CATCH BASIN CONNECTION

GRIND 3" OF AC PRIOR TO COMMENCEMENT OF REMOVALS. SEE DETAIL ON SHEET-1.

CONSTRUCT CLEANOUT PER DETAIL HEREON

MODIFY EXISTING FACILITY AND REPLACE WITH PER DETAIL HEREON

NOTES:

1. SAWCUT EXISTING OUTLET AT REAR ANGLE POINT AS INDICATED ON PLAN VIEW.
2. SAWCUT EXISTING CURB AND GUTTER AT WESTERLY CORNER OF OUTLET.
3. REMOVE EXISTING OUTLET BETWEEN SAWCUT LINES AND REPLACE WITH MODIFIED CLEANOUT, CURB, GUTTER AND SIDEWALK.
4. "D" DIMENSION SHALL BE SIZED TO MATCH EXISTING OUTLET OPENING AT JOIN.
5. SIDE OPENING SHALL BE CONSTRUCTED TO MATCH EXISTING OPENING AT EASTERLY SAWCUT JOIN.

CLEANOUT @ STA 127+85 (SECTION)

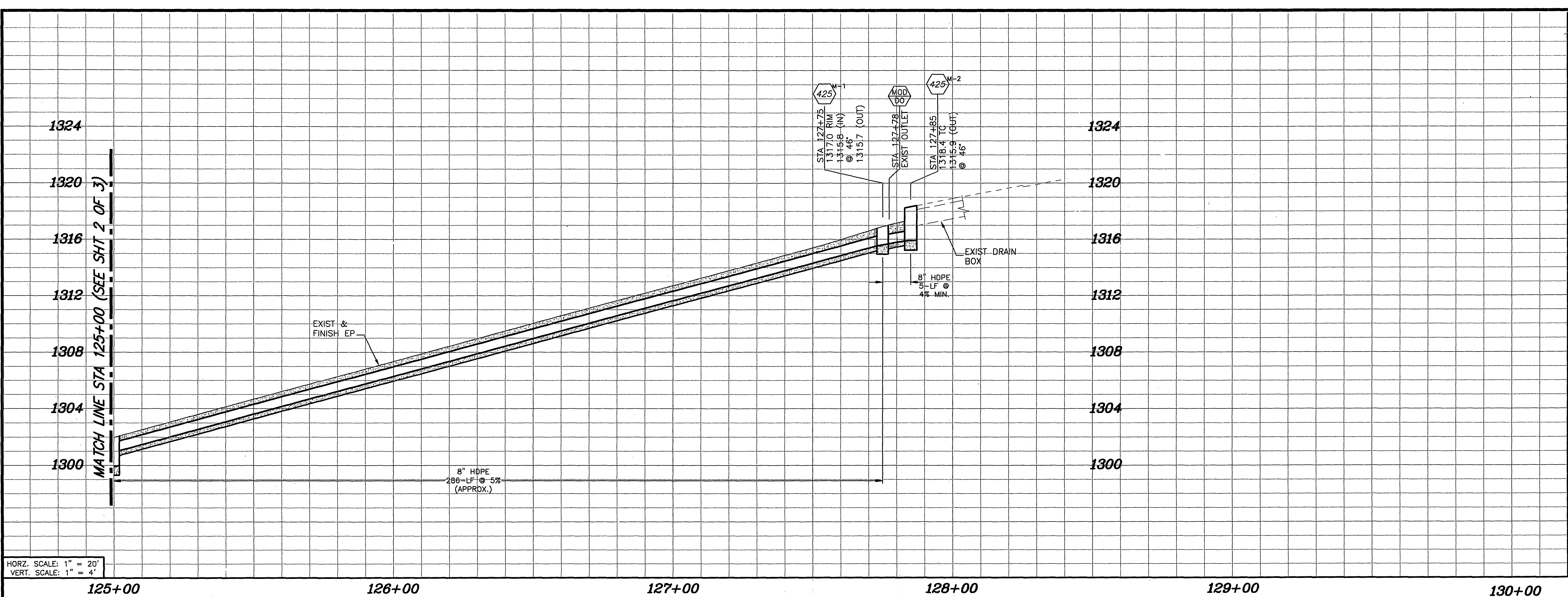
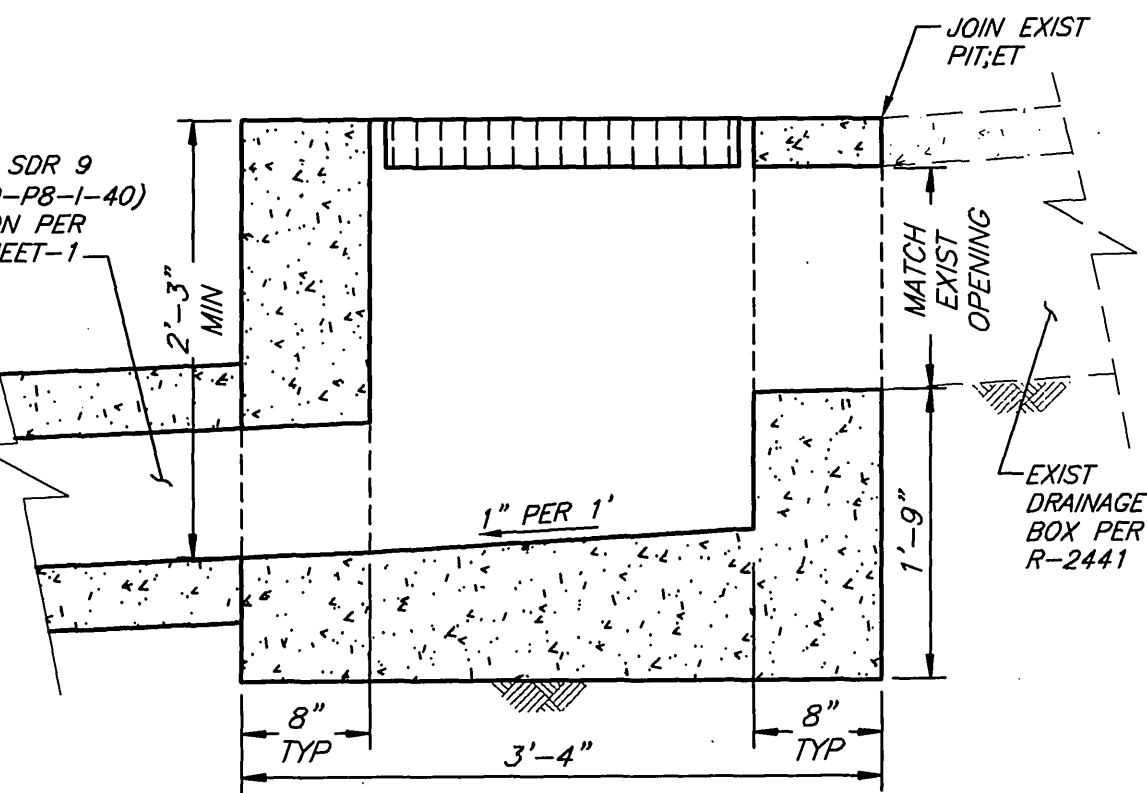

HORZ. SCALE: 1" = 20'
VERT. SCALE: 1" = 4'

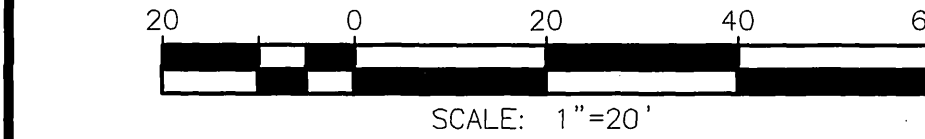
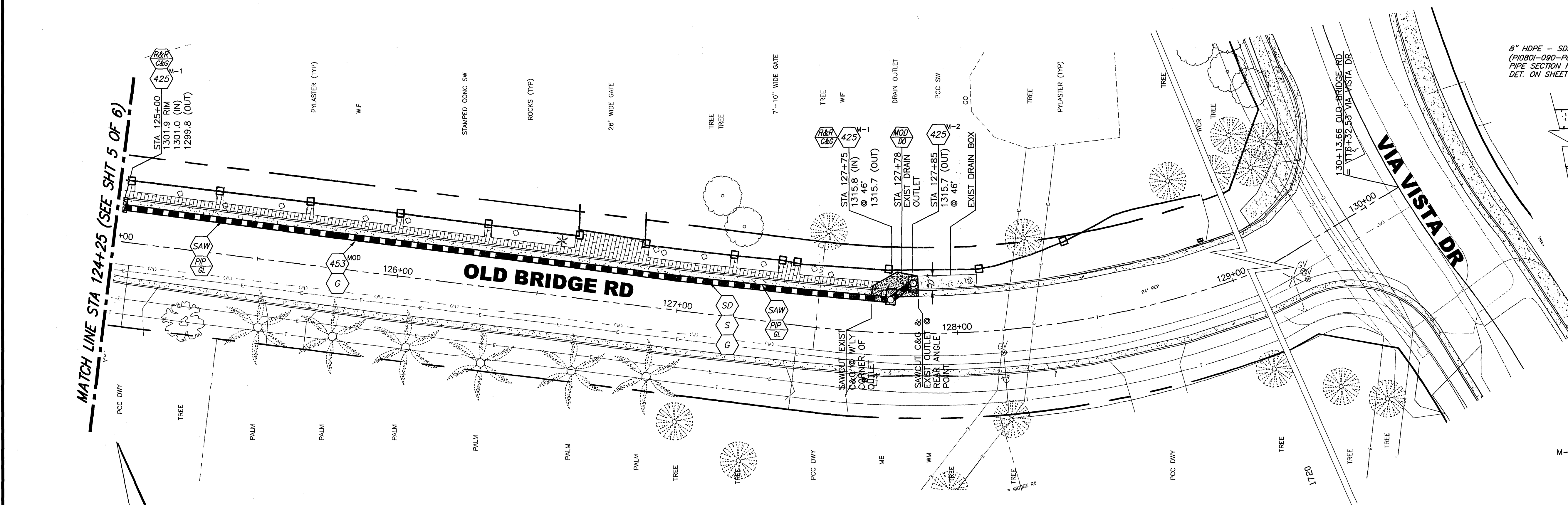

ELEVATIONS AND STATIONS ARE APPROXIMATE ON ALL PLANS

Underground Service Alert
CALL BEFORE YOU DIG
CALL TOLL FREE
1-800-227-2600
TWO WORKING DAYS BEFORE YOU DIG

ENGINEER IN RESPONSIBLE CHARGE
Edward Lara
R.C.E. No. 63763 expires 9/30/10
DATE September 22, 2009

CITY OF RIVERSIDE, CALIFORNIA
PUBLIC WORKS DEPARTMENT
APPROVED BY: [Signature]
DATE: 9/30/09
DESIGNED BY: JUE DRAWN BY: JUE CHECKED BY: EL

HACIENDA DR. STORM DRAIN & OLD BRIDGE RD. STORM DRAIN IMPROVEMENTS
OLD BRIDGE RD. STA 125+00 STA 130+00
HORIZ. SCALE: 1" = 20'
VERT. SCALE: 1" = 4'
SHEET 6 OF 6
FILE NO.