

SUPPLEMENTAL REPORT

1. Original File No. P15028755	2.	3. Off ID 223	4. Dist. E	5. Crime-Ct.	6. Crime-Ct.	7. Crime-Ct.	8. Date/Time Occurred	9. Day		
10. Date/Time Assigned 02/23/15 2320	11. Date/Time Inv. Start 02/24/15 0014		12. Date/Time Inv. Term. 02/24/15 0700		13. Type Clr. EXC	14. Type Cont. REC	15. Additional Adults Arr.	16. Additional Juv. Arr.		
17. Address of Occurrence (Street No. - Name - City) 2865 Prospect Ave. Rvsvd							18. Type of Place Residence			
For ID USE: V = Victim, I = Informant, W = Witness, O = Other										
19. ID:	20. Last Name - First - Middle (Firm Name if Business)					21. Race - Sex	22. DOB			
23. Residence Address			24. Business or School Address			25. Home Phone	26. Bus. Phone			
Comments:			E-mail Address			Cell Phone	Pager Number			
35. LAST Name - First - Middle			36. Race - Sex	37. Age	38. Ht.	39. Wt.	40. Hr	41. Eyes	42. DOB or ID	43. Arrested <input type="checkbox"/> Yes <input type="checkbox"/> No
44. Address - Clothing - Other Marks or Identifying Characteristics										
45. Juv. Other Disp. Juris. <input type="checkbox"/> 2			Juv. Ct. Prob. <input type="checkbox"/> 5		Within Dept. <input type="checkbox"/> 6		Detained <input type="checkbox"/> 1		Not Detained <input type="checkbox"/> 2	

ORIGINALLY REPORTED DOLLAR VALUES ARE CHANGED AS SHOWN BELOW

Cat.	A Currency Notes	B Jewelry Prec. Met.	C Clothing Furs	E Office Equip.	F T.V.-Radio Cameras	G Firearms	H Household Goods	I Consum. Goods	J Livestock	K Misc.
PS	\$	\$	\$	\$	\$	\$	\$	\$	\$	\$
57										
PR	\$	\$	\$	\$	\$	\$	\$	\$	\$	\$

60. Originally Reported Offenses (Code - Crime)					61. Original Offenses Changed to (Code - Crime)					58. Stolen Auto Value ASP: \$ _____	
(1) OIS					(1)					59. Recovered Auto Value A2 \$ _____	
(2)					(2)						
(3)					(3)						

Reporting Officer T. Ellis	Reviewed By McKay #1122	Copies To:	APR Sent:	APB Sent:
VCLO	DOJ-NCIC Entered:	Cancelled:	ENTERED:	STATS:
()			ARBK:	ANK:

Narrative of Supplemental Report:

On 02/23/15 at approx 2320 hrs, I was contacted by Senior Forensic Technician S. McKay-Davis and told to respond to 2865 Prospect Ave. ref an OIS investigation. Upon my arrival at approx 0014 hrs, I contacted Sgt. T. Banks and was assigned to assist Senior Forensic Technician S. McKay-Davis with the processing of the scene. I took measurements of the evidence items and completed a sketch (see attached diagram) of the area. I cleared at approx 0625 hrs.

Alley

Wood Telephone Pole

Chain Link Gates
11 10 8

Locked Chain Link Gate

Chain Link Fence

Mattress

Dog House Pen

Gate

Basketball Hoop

Batting Cage

Tree

Lawn Mower

6

5

Wood Fence 6' Tall

6' High Chain Link Fence

Back Yard

Planter

Wood Fence 6' Tall

4' high Wire

Garden

Shed

Side Walk

Rock

Metal Shed 4'

Back

Shed

Shed

Bark Ground Cover

Shed

RIVERSIDE POLICE DEPT - Restricted Information
Public Records Act Request
JPEDROZA 11/17/2016 2:17:11 PM Unauthorized Release PROHIBITED

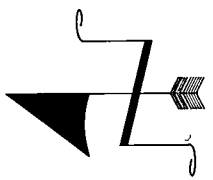

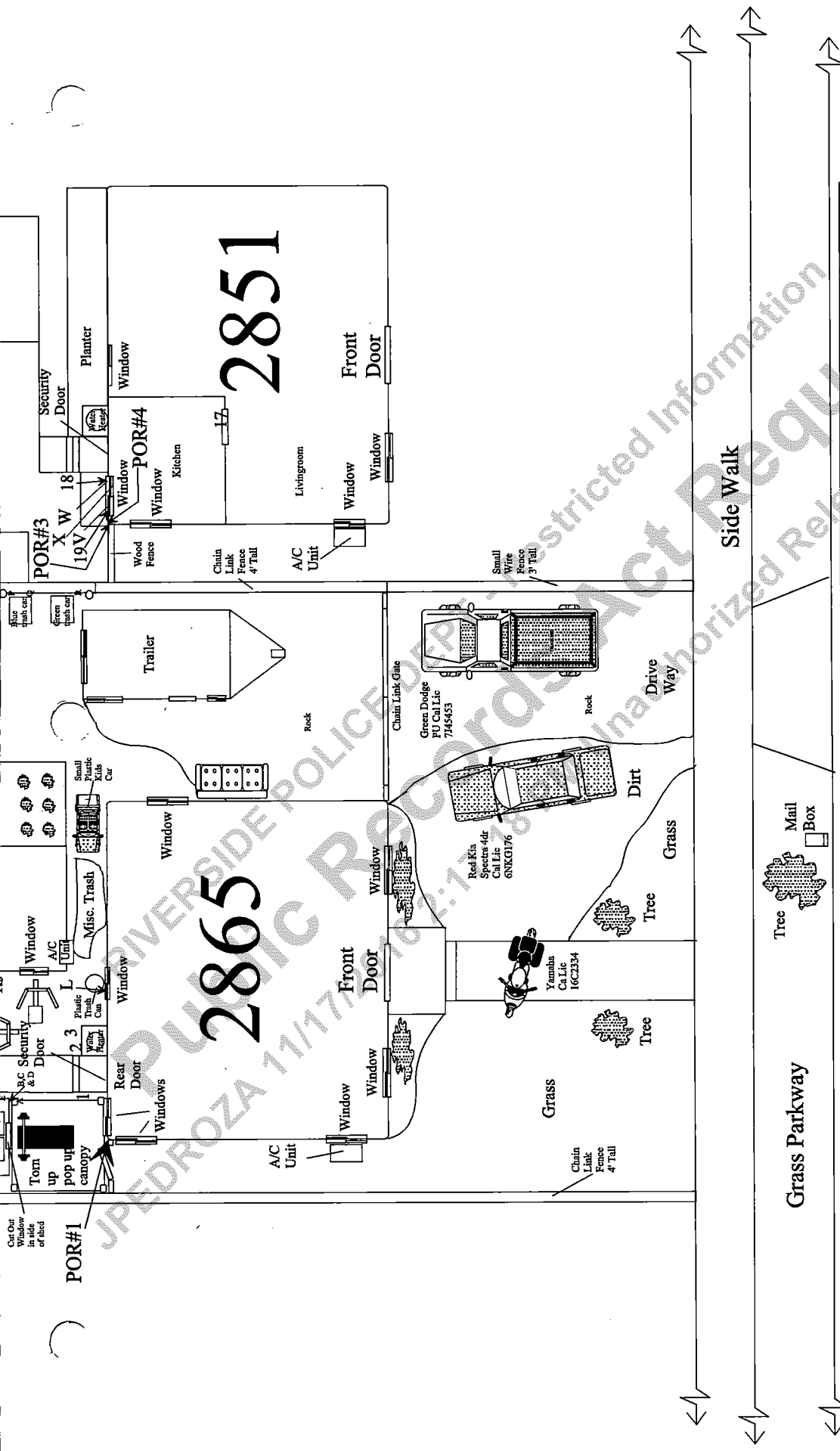

File No#: P15028755 Date: 02/23/15 Crime: O.I.S.
 Location: 2865 Prospect Ave. Scene Det. D. Smith & M. Medici
 Drawn By: T. Ellis Scale: 3/32 = 1'
 For Location and Description of Evidence Items see Senior
 Forensic Technician Selena McKay-Davis Evidence Log.

Pleasant St.

4567

2916

2892

2878

2864

2850

4587

Park Ave.

4575

POR # 2
Wood Telephone
Pole # 12036J



Unit 5507

Boarded up
Window
Detached
Garage

Wood Tele Pole

6' High Wood Fence

4580

6' High Wood Fence

2879

Alley

Wood Telephone Pole

4591

2893

Brick Wall

6' High Wood Fence

6' High Wood Fence

6' High Wood Fence

6' High Wood Fence

6' High Wood Fence

6' High Wood Fence

6' High Wood Fence

6' High Wood Fence

6' High Wood Fence

6' High Wood Fence

6' High Wood Fence

6' High Wood Fence

6' High Wood Fence

6' High Wood Fence

6' High Wood Fence

6' High Wood Fence

6' High Wood Fence

6' High Wood Fence

6' High Wood Fence

6' High Wood Fence

6' High Wood Fence

6' High Wood Fence

6' High Wood Fence

6' High Wood Fence

6' High Wood Fence

6' High Wood Fence

6' High Wood Fence

6' High Wood Fence

6' High Wood Fence

6' High Wood Fence

6' High Wood Fence

6' High Wood Fence

6' High Wood Fence

6' High Wood Fence

6' High Wood Fence

6' High Wood Fence

6' High Wood Fence

6' High Wood Fence

6' High Wood Fence

Prospect Ave.

File No#: P15028755 Date: 02/23/15
Location: 2865 Prospect Ave. Scene De
Drawn By: T. Ellis Scale: 3/32 = 1"
For Location and Description of E
Forensic Technician Selena McKay-Da



2838

2836

2822

2808

2794

2786

Grove
Ave.

2837

2823

2809

2795

2787

Crime: O.I.S.
by: D. Smith & M. Medici
See [] ms see Senior
[] Evidence Log.

RIVERSIDE POLICE DEPT - Restricted Information
Public Records Act Request
JPEDROZA 11/17/2016 2:17:21 PM Unauthorized Release PROHIBITED