

**SUPPLEMENTAL REPORT**

1. Original File No. P12024811	2.	3. Off ID 223	4. Dist. W	5. Crime-Ct.	6. Crime-Ct.	7. Crime-Ct.	8. Date/Time Occurred	9. Day			
10. Date/Time Assigned J2/18/12 1500	11. Date/Time Inv. Start 02/18/12 1500		12. Date/Time Inv. Term. 02/23/12 1330		13. Type Clr.	14. Type Cont.	15. Additional Adults Arr.	16. Additional Juv. Arr.			
17. Address of Occurrence (Street No. – Name – City) On Harold St. N/O Gramercy Pl. Rvsd							18. Type of Place City Streets				
For ID USE: V = Victim, I = Informant, W = Witness, O = Other											
19. ID:	20. Last Name – First – Middle (Firm Name if Business)					21. Race – Sex		22. DOB			
23. Residence Address			24. Business or School Address			25. Home Phone		26. Bus. Phone			
Comments:			E-mail Address			Cell Phone		Pager Number			
S U S P E C T	35. LAST Name – First – Middle			36. Race – Sex	37. Age	38. Ht.	39. Wt.	40. Hr	41. Eyes	42. DOB or ID	43. Arrested <input type="checkbox"/> Yes <input type="checkbox"/> No
	44. Address – Clothing – Other Marks or Identifying Characteristics										
45. Juv. Other Disp: Juris. <input type="checkbox"/> 2		Juv. Ct. Prob. <input type="checkbox"/> 5		Within Dept. <input type="checkbox"/> 6		Detained <input type="checkbox"/> 1		Not Detained <input type="checkbox"/> 2			

ORIGINALLY REPORTED DOLLAR VALUES ARE CHANGED AS SHOWN BELOW

Cat.	A Currency Notes	B Jewelry Prec. Met.	C Clothing Furs	E Office Equip.	F T.V.-Radio Cameras	G Firearms	H Household Goods	I Consum. Goods	J Livestock	K Misc.
PS	\$	\$	\$	\$	\$	\$	\$	\$	\$	\$
57										
PR	\$	\$	\$	\$	\$	\$	\$	\$	\$	\$

60. Originally Reported Offenses (Code – Crime)					61. Original Offenses Changed to (Code – Crime)					58. Stolen Auto Value ASP: \$	
(1) OIS					(1)						
(2)					(2)					59. Recovered Auto Value A2 \$	
(3)					(3)						

Reporting Officer T. Ellis <i>TE</i>		Reviewed By <i>[Signature]</i>		Copies To:		APR Sent:		APB Sent:			
						APR Canx:		APB Canx:			
VCL0 ( )	DOJ-NCIC Entered:	Cancelled:	ENTERED:	STATS:	ARBK:	ANK:	Page 1				

**Narrative of Supplemental Report:**

On 02/18/12 at approx 1500 hrs, I was contacted by Sgt. Dinco and told to respond to Harold St. north of Gramercy Pl. ref an OIS investigation. Upon my arrival at approx 1546 hrs, I contacted Sgt. Amador and was assigned to assist Det. Medici with the processing of the scene. I took super 8 digital video (ME-27) of the area and began taking digital photographs of the scene (see attached photo logs). I located and collected items ME-01 thru ME-26 and completed a sketch of the scene (see attached diagram). I cleared at approx 2115 hrs, and transported items ME-01 thru ME-27 to the Magnolia St. Station for further processing and placed them in my locked evidence cabinet. I then downloaded the digital photographs at the Magnolia St. Station Forensics Unit Office computer to a secured file format. On 02/21/12 at approx 0726 hrs, I removed item ME-26 (shoes and socks) from my locked evidence cabinet and released it to Senior Forensic Technician S. McKay/Davis (for Pathologist review). On 02/21/12 at approx 1251 hrs, I received item ME-26 back my Senior Forensic Technician S. McKay/Davis and placed it back into my locked evidence cabinet. On 02/21/12 at approx 1430 hrs, I removed item ME-27 (Super 8 digital scene video) from my locked evidence cabinet and made a DVD Copy (item ME-28) of item ME-27. I placed items ME-27 & ME-28 into my locked evidence cabinet. On 02/23/12 at approx 1330 hrs, I removed items ME-01 thru ME-28 from my locked evidence cabinet and placed items ME-1 thru ME-8 & ME-10 thru ME-28 into property via the Magnolia St. Station property lockers. I released items ME-9, ME-9A & ME-9B to Senior Forensics Technician S. Lane (to be processed for latent fingerprints, DNA & to be taken to DOJ).



# PHOTO-LOG RIVERSIDE POLICE DEPARTMENT

FILE: P12024811

ADDRESS: On Harold St. N/O Gramercy Pl.

DATE: 02/18/12

CRIME: OIS

PAGE: 1 of 5.

PHOTOGRAPHER: T. Ellis

Photo I.D. #	TIME	DIR	DESCRIPTION
C2I55060	1745	S	O/A of scene.
C2I55061		S	O/A of scene.
C2I55062		S	O/A of scene.
C2I55063		S	O/A of scene.
C2I55064		S	O/A of scene.
C2I55065		W	O/A of scene.
C2I55066		N/W	O/A of scene.
C2I55067		N	O/A of scene.
C2I55068		N	O/A of scene.
C2I55069		N	O/A of scene.
C2I55070		N	O/A of scene.
C2I55071		N	O/A of scene.
C2I55072		N	O/A of scene.
C2I55073		N	O/A of scene.
C2I55074		N	O/A of body.
C2I55075		N	O/A of body.
C2I55076		Down	O/A of body.
C2I55077		Down	O/A of body.
C2I55078		Down	O/A of body.
C2I55079		Down	C/U of the face.
C2I55080		Down	O/A of body.
C2I55081		Down	O/A of body.
C2I55082		Down	O/A of handgun.
C2I55083		S	O/A of scene.
C2I55084		S	O/A of scene.
C2I55085		S	O/A of scene.
C2I55086		S	O/A of the drive way at 5652 Harold St.
C2I55087		S	O/A of body.
C2I55088		Down	M/S of handgun.
C2I55089		S	O/A of body.
C2I55090		S	M/S of handgun by body.
C2I55091		Down	M/S of magazine by body.
C2I55092		S	O/A of RPD black & white unit 3616.
C2I55093		S	C/U of the license plate of RPD black & white unit 3616.
C2I55094		S/W	O/A of RPD black & white unit 3616.
C2I55095	1751	N	O/A of RPD black & white unit 3616.

KEY=(C/U=Close-up) (M/S=Medium shot) (O=Overall shot) (R/S=Right side) (L/S=Left side)



# PHOTO-LOG RIVERSIDE POLICE DEPARTMENT

E: P12024811

ADDRESS: On Harold St. N/O Gramercy Pl.

DATE: 02/18/12

CRIME: OIS

PAGE: 2 of 5.

PHOTOGRAPHER: T. Ellis

Photo I.D. #	TIME	DIR	DESCRIPTION
C2I55096	1751	N/E	O/A of RPD black & white unit 3616.
C2I55097		N/E	O/A of RPD black & white unit 3616.
C2I55098		Down	O/A of Bike.
C2I55099		N/E	O/A of bike.
C2I55100		N/W	O/A of Bike.
C2I55101		Down	O/A of Bike.
C2I55102		W	O/A of the vehicles in the driveway at 5664 Harold St.
C2I55103		W	C/U of the license plate of a chevy Suburban in the driveway at 5664 Harold St.
C2I55104		E	O/A of Chevy Suburban in driveway at 5664 Harold St.
C2I55105		E	O/A of Chevy Corvette in driveway at 5664 Harold St.
C2I55106		S/E	O/A view from the garage @ 5664 Harold to the sidewalk were the body was located.
C2I55107		W	O/A of Chevy Corvette in driveway at 5664 Harold St.
C2I55108		W	C/U of the license plate of a chevy Corvette in the driveway at 5664 Harold St.
C2I55109		S	O/A of scene.
C2I55110		S	O/A of scene.
C2I55111		S	O/A of scene.
C2I55112		S/W	O/A of [REDACTED] in front of 5638 Harold St.
C2I55113		N/W	O/A of [REDACTED] in front of 5638 Harold St.
C2I55114		N/W	C/U of the license plate of [REDACTED] in front of 5638 Harold St.
C2I55115		N/E	O/A of [REDACTED] in front of 5638 Harold St.
C2I55116		S/E	O/A of [REDACTED] in front of 5638 Harold St.
C2I55117		W	O/A of scene.
C2I55118		W	O/A of the vehicles in the driveway of 5652 Harold St.
C2I55119		W	O/A of vehicle in the driveway of 5652 Harold St.
C2I55120		W	C/U of the license plate of vehicle in the driveway of 5652 Harold St.
C2I55121		S	O/A of vehicle in the driveway of 5652 Harold St.
C2I55122		S	O/A of vehicle in the driveway of 5652 Harold St.
C2I55123		N/E	O/A of vehicle in the driveway of 5652 Harold St.
C2I55124		S/E	O/A of vehicle in the driveway of 5652 Harold St.
C2I55125		S/E	O/A of vehicle in the driveway of 5652 Harold St.
C2I55126		W	O/A of vehicle in the driveway of 5652 Harold St.
C2I55127		W	C/U of the license plate of vehicle in the driveway of 5652 Harold St.
C2I55128		W	O/A of vehicle in the driveway of 5652 Harold St.
C2I55129		E	O/A of scene.
C2I55130		E	O/A of scene.
C2I55131	1803	E	O/A of scene.

KEY=(C/U=Close-up) (M/S=Medium shot) (O=Overall shot) (R/S=Right side) (L/S=Left side)



# PHOTO-LOG RIVERSIDE POLICE DEPARTMENT

FILE: P12024811

ADDRESS: On Harold St. N/O Gramercy Pl.

DATE: 02/18/12

CRIME: OIS

PAGE: 3 of 5.

PHOTOGRAPHER: T. Ellis

Photo I.D. #	TIME	DIR	DESCRIPTION
C2I55132	1803	N/W	O/A of scene.
C2I55133		N/E	O/A of [REDACTED] on Harold St.
C2I55134		N/W	O/A of [REDACTED] on Harold St.
C2I55135		N/W	C/U of the license plate of [REDACTED] on Harold St.
C2I55136		S/W	O/A of [REDACTED] on Harold St.
C2I55137		S/E	O/A of [REDACTED] on Harold St.
C2I55138		N	O/A of scene.
C2I55139		N	O/A of scene.
C2I55140		N	O/A of scene.
C2I55141		N	O/A of items 1, 2, 3 & 4.
C2I55142		N	O/A of items 2, 3 & 4.
C2I55143		N	O/A of items 5, 6, 7, 8, 9 & 10.
C2I55144		N	O/A of items 6, 7, 8, 9, 10 & 11.
C2I55145		N	O/A of items 7, 8, 9, 10 & 11.
C2I55146		N	O/A of items 6, 7, 8, 9, 10 & 11.
C2I55147		S	O/A of item 15.
C2I55148		S	O/A of item 14.
C2I55149		S	O/A of items 13 & 14.
C2I55150		S	O/A of items 6, 7, 8, 9, 10, 11 & 12.
C2I55151		S	O/A of items 5, 6, 7, 8, 9, 10 & 11.
C2I55152		S	O/A of items 1, 2, 3 & 4.
C2I55153		S	O/A of items 1, 2, 3 & 4.
C2I55154		E	O/A of items 1, 2, 3 & 4.
C2I55155		E	O/A of item 1.
C2I55156		E	O/A of items 2, 3 & 4.
C2I55157		Down	C/U of item 1.
C2I55158		Down	C/U of item 2.
C2I55159		Down	C/U of item 3.
C2I55160		Down	C/U of item 4.
C2I55161		Down	C/U of item 5.
C2I55162		Down	C/U of item 6.
C2I55163		Down	C/U of item 7.
C2I55164		Down	C/U of item 8.
C2I55165		Down	C/U of item 9.
C2I55166		Down	C/U of item 10.
C2I55167	1819	Down	C/U of item 11.

KEY=(C/U=Close-up) (M/S=Medium shot) (O=Overall shot) (R/S=Right side) (L/S=Left side)



# PHOTO-LOG RIVERSIDE POLICE DEPARTMENT

E: P12024811

ADDRESS: On Harold St. N/O Gramercy Pl.

DATE: 02/18/12

CRIME: OIS

PAGE: 4 of 5.

PHOTOGRAPHER: T. Ellis

Photo I.D. #	TIME	DIR	DESCRIPTION
C2I55168	1820	Down	C/U of item 12.
C2I55169		Down	C/U of item 13.
C2I55170		Down	C/U of item 14.
C2I55171		Down	C/U of item 15.
C2I55172		Down	C/U of item 9.
C2I55173		Down	C/U of item 9.
C2I55174		N/E	O/A of the drivers side of RPD black & white unit 3616.
C2I55175		E	O/A of the inside of RPD black & white unit 3616.
C2I55176		E	O/A of the inside of RPD black & white unit 3616.
C2I55177		S/E	O/A of the inside of RPD black & white unit 3616.
C2I55178		W	O/A of the inside of RPD black & white unit 3616.
C2I55179		W	O/A of the inside of RPD black & white unit 3616.
C2I55180		W	O/A of the inside of RPD black & white unit 3616.
C2I55181		W	O/A of item 16A inside of RPD black & white unit 3616.
55182		W	C/U of item 16A inside of RPD black & white unit 3616.
C2I55183		N	O/A of item A.
C2I55184		S	O/A of item A.
C2I55185		Down	C/U of item A.
C2I55186		W	O/A of the body.
C2I55187		S	O/A of the body.
C2I55188		N	O/A of the body.
C2I55189		Down	O/A of the body.
C2I55190		Down	C/U of the face.
C2I55191		Down	M/S of the wound to the left side of the body.
C2I55192		Down	O/A of the body.
C2I55193		Down	M/S of the body.
C2I55194		Down	M/S of tattoo to the left side of chest.
C2I55195		Down	M/S of tattoo to the right side of chest.
C2I55196		Down	M/S of tattoo to the right side of chest.
C2I55197		Down	M/S of the right leg.
C2I55198		Down	M/S of the left leg.
C2I55199		Down	M/S of the jacket.
5200		Down	M/S of the jacket.
C2I55201		Down	M/S of the jacket.
C2I55202		W	O/A of the back of the jacket.
C2I55203	2012	W	O/A of the back of the legs.

KEY=(C/U=Close-up) (M/S=Medium shot) (O=Overall shot) (R/S=Right side) (L/S=Left side)



## EVIDENCE LOG

FILE: P12024811  
 DATE: 02/18/12  
 LOCATION: 5652 Harold St. Rvsvd  
 TECHNICIAN: T. Ellis

P.O.R. # 1. is a metal street light pole #SL505666  
 P.O.R. # Located 2'3" E/O the E/Curb of Harold St.  
 P.O.R. # & 377' S/O the S/Curb of Philbin Ave.  
 P.O.R. # 2. is the pass/side front seat of RPD Unit  
 P.O.R. # 3616.  
 P.O.R. #

EVID NUM	COLL TIME	DESCRIPTION OF EVIDENCE	POR	N	S	E	W	HT
ME-01	1855	(1) Winchester 45 auto spent casing.	1	17'10"			53'8"	
ME-02	1855	(1) Winchester 45 auto spent casing.	1	29'1"			56'3"	
ME-03	1855	(1) Winchester 45 auto spent casing.	1	29'4"			54'9"	
ME-04	1856	(1) Winchester 45 auto spent casing.	1	28'8"			53'	
ME-05	1856	(1) Winchester 45 auto spent casing.	1	20'5"			49'1"	
ME-06	1857	(1) Winchester 45 auto spent casing.	1	23'9"			49'11"	
ME-07	1858	(1) Winchester 45 auto spent casing.	1	25'2"			49'11"	
ME-08	1905	(1) Swab sample of possible blood, (1) Control swab & (1) Reagent swab.	1	27'			48'1"	
ME-09	1917	(1) blue steel Colt 45 semi auto handgun (see charting form for more info).	1	27'			47'5"	
ME-9A	1917	(1) Federal 45 auto live round, removed from the chamber of item ME-09.	1					
ME-9B	1917	(1) blue steel magazine containing (6) Federal 45 auto live rounds removed from item ME-09.	1					
ME-10	1858	(1) Tan Jacket hood.	1	25'2"			46'7"	
ME-11	1955	(1) Grey Under Armor Baseball style cap.	1	26'4"			45'8"	
ME-12	1900	(1) Empty stainless steel magazine with no#177 on it.	1	32'			43'8"	
ME-13	1901	(1) Winchester 45 auto spent casing.	1	36'7"			48'1"	
ME-14	1902	(1) Winchester 45 auto spent casing.	1	45'9"			44'8"	
ME-15	2040	(1) Red Moti V multi speed mountain style bike and (1) small black flashlight.	1	68'2"			43'8"	
ME-16	2050	(1) Winchester 45 auto spent casing.	1	38'5"			54'3"	
ME-16A	1924	Metro Tactical Operations plan paperwork.	2					

**KEY: POR= POINT OF REFERENCE, N = NORTH, S = SOUTH, E = EAST, W = WEST, HT = HEIGHT  
 COLL. TIME = COLLECTION TIME, EVID. NUM= EVIDENCE ITEM NUMBER**

## EVIDENCE LOG

P.O.R. # 1. is a metal street light pole #SL505666  
 P.O.R. # Located 2'3" E/O the E/Curb of Harold St.  
 P.O.R. # & 377' S/O the S/Curb of Philbin Ave.  
 P.O.R. # 3. is the deceased body of Danny Bond  
 P.O.R. # on the sidewalk in front of 5652 Harold St.  
 P.O.R. #

FILE: P12024811  
 DATE: 02/18/12  
 LOCATION: 5652 Harold St. Rvsvd  
 TECHNICIAN: T. Ellis

EVID NUM	COLL TIME	DESCRIPTION OF EVIDENCE	POR	N	S	E	W	HT
ME-17	2050	(1) Winchester 45 auto spent casing.	1	39'9"			52'6"	
ME-18	2051	(1) Winchester 45 auto spent casing.	1	46'4"			44'2"	
ME-19	1936	(1) Swab sample from possible strike mark (item A) on sidewalk & (1) Control swab.	1	28'2"			49'6"	
ME-20	2014	(1) lead & Copper projectile and possible fragments from under Danny Bond (deceased) at scene.	3					
ME-21	2014	(1) set of Handcuffs removed from Danny Bond (deceased) at scene by Coroner.	3					
ME-22	2016	(1) GSR Kit from the hands of Danny Bond (deceased) at scene.	3					
ME-23	2025	(11) Keys, a magnifying glass & a car remote removed from Danny Bond @ scene by Coroner..	3					
ME-24	2025	(1) Screw & (1) bean bag ball removed from Danny Bond @ scene by Coroner..	3					
ME-25	2026	(1) Tan heavy jacket removed from Danny Bond @ scene by Coroner.	3					
ME-26	2058	(1) Pair of white & blue New Balance shoes & (1) pair of white socks removed from Danny Bond @ scene by Coroner.	3					
ME-27	1719	(1) Super 8 digital video of scene.						
ME-28	1500	(1) DVD Copy of scene video, done on 2/21/12 by T. Ellis						
A	photo only	Possible strike mark to the sidewalk in front of 5652 Harold St (swab was marked as item ME-19).	1	28'2"			49'6"	
		M= Medici & E=Ellis						

**KEY: POR= POINT OF REFERENCE, N = NORTH, S = SOUTH, E = EAST, W = WEST, HT = HEIGHT  
 COLL. TIME = COLLECTION TIME, EVID. NUM= EVIDENCE ITEM NUMBER**



**Riverside Police Department  
PROPERTY REPORT**

File No.  
P12024811

Date/Time  
02/18/12 -14:45

Type of Complaint <b>OIS - OFFICER INVOLVED SHOOTING</b>		Address <b>5652 HAROLD</b>			
Victim	DOB	Sex	Race	Address	
Arrestee / Suspect	DOB	Sex	Race	Address	
Arrestee / Suspect	DOB	Sex	Race	Address	
Arrestee / Suspect	DOB	Sex	Race	Address	
Finder	DOB	Sex	Race	Address	Phone No.

By Officer(s) <i>T. Jones</i>	ID No. <i>223</i>	Supv. Approving <i>Johnson</i>	RMC/RSC Case No.	Property Clerk
----------------------------------	----------------------	-----------------------------------	------------------	----------------

Item	Owner	Itemize, Describe, List Serial Numbers... Only 1 Article per line	Prop. Loc.	Rel. Dispo
ME-01		(1) Winchester 45 auto spent casing.	RET	
ME-02		(1) Winchester 45 auto spent casing.	RET	
ME-03		(1) Winchester 45 auto spent casing.	RET	
ME-04		(1) Winchester 45 auto spent casing.	RET	
ME-05		(1) Winchester 45 auto spent casing.	RET	
ME-06		(1) Winchester 45 auto spent casing.	RET	
ME-07		(1) Winchester 45 auto spent casing.	RET	
ME-08		(1) swab of possible blood, (1) control swab & (1) reagent swab.	RET	
ME-09		(1) blue steel Colt M1991A1 series 80 semi auto 45 ca handgun, serial# 2706138.	RET	
ME-10		(1) tan jacket hood.	RET	
ME-11		(1) grey Under Armor baseball style cap.	RET	
ME-12		(1) empty stainless steel magazine with no#177 on it.	RET	
ME-13		(1) Winchester 45 auto spent casing.	RET	
ME-14		(1) Winchester 45 auto spent casing.	RET	
ME-15		(1) red Moti V multi speed mountain style bike & (1) small black flashlight.	RET	
ME-16		(1) Winchester 45 auto spent casing.	RET	
ME-16A		Metro Tactical Operations Plan paperwork.	RET	
ME-17		(1) Winchester 45 auto spent casing.	RET	
ME-18		(1) Winchester 45 auto spent casing.	RET	
ME-19		(1) sample swab & (1) control swab.	RET	
ME-20		(1) lead & copper projectile & fragments.	RET	
ME-21		(1) set of chrome hand cuffs mod 700, serial no# 376936.	RET	
ME-22		(1) GSR Kit.	RET	
ME-23		(11) keys, a Magnifying glass & a car remote.	RET	
ME-24		(1) screw & (1) bean bag ball.	RET	
ME-25		(1) tan heavy jacket.	RET	

**Riverside Police Department  
PROPERTY REPORT**

File No. P12024811	Date/Time 02/18/12 -14:45
-----------------------	------------------------------

Type of Complaint OIS - OFFICER INVOLVED SHOOTING		Address 5652 HAROLD			
Arrestee / Suspect	DOB	Sex	Race	Address	
Arrestee / Suspect	DOB	Sex	Race	Address	
Finder	DOB	Sex	Race	Address	Phone No.

Item	Owner	Itemize, Describe, List Serial Numbers... Only 1 Article per line	Prop. Loc.	Rel. Dispo
ME-26		(1) pair of white & blue New Balance shoes & (1) pair of white socks.	RET	
ME-27		(1) Super 8 digital scene video.	RET	
ME-28		(1) DVD Copy of scene video.	RET	
ME-9A		(1) Federal 45 auto live round.	RET	
ME-9B		(1) blue steel magazine containing (6) Federal 45 auto live rounds.	RET	

\* Last Item \*

RIVERSIDE POLICE DEPT - Restricted Information  
**Public Records Act Request**  
 ROZ 2/22/2014 10:18:18 AM Unauthorized Release PROHIBITED



**CITY OF RIVERSIDE POLICE DEPARTMENT  
IDENTIFICATION SECTION**

<b>FILE#:</b> P12024811	<b>CRIME:</b> OIS
<b>DATE:</b> 2/18/12	<b>I.D. TECH:</b> T. Ellis
<b>TIME:</b> 1917 hrs.	<b>OFFICER:</b>

**SEMI-AUTO PISTOL CHART FORM**

Chamber (1) Federal 45 Auto Live Round.



Magazine:
(1) Federal 45 Auto Live Round.
(1) Federal 45 Auto Live Round.
(1) Federal 45 Auto Live Round.
(1) Federal 45 Auto Live Round.
(1) Federal 45 Auto Live Round.
(1) Federal 45 Auto Live Round.

Brand Name: Colt	Hammer Position: Cocked back.
Serial No: 2706138.	Safety Position: On
Model: M1991A1 Series 80.	Other Descriptive Info: Blue Steel with rubber grips.
Caliber: 45	Location Found (How Received): On sidewalk at Scene, in front of 5652 Harold St.
Additional Remarks: The handgun was markrd as item ME-09 (and had possible blood all over it), the live round that was removed from the chamber was marked as item ME-09A and the magazine containing (6) live rounds was marked as item ME-09B.	

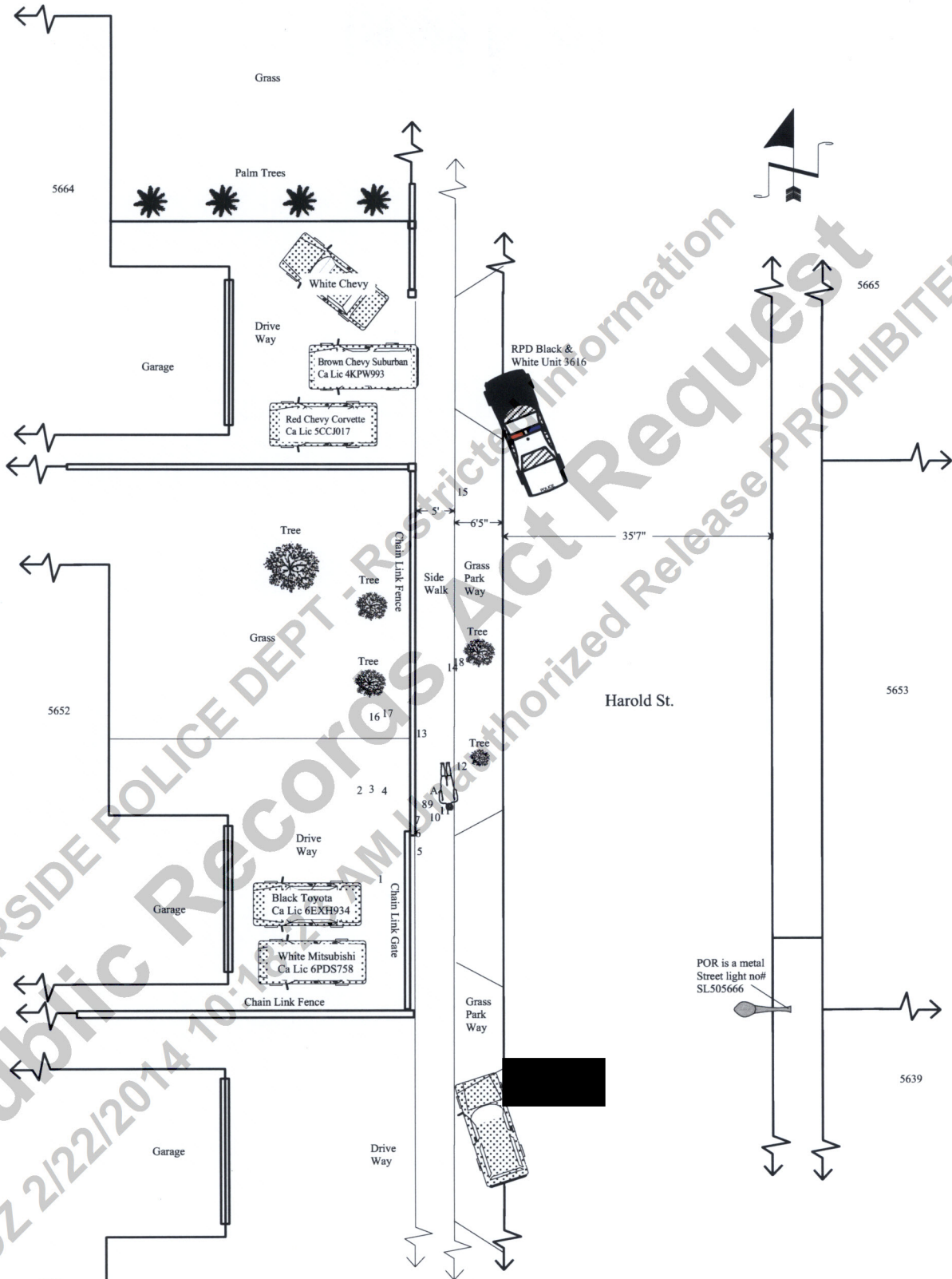

File No#: P12024811 Date: 02/18/12 Crime: O.I.S.  
 Location: On Harold St. N/O Gramercy Pl.  
 Scene Det: M. Medici Drawn By: T. Ellis  
 Scale: 3/32 = 1' For a Description and Location of  
 Evidence Items see attached Evidence Logs.